



## Sistemas de elevación y transporte para cargas pesadas de hasta 200 t





## GKS-PERFEKT ▶▶ Table of Contents

Products	Load Capacity	Page
<b>Hydraulic Toe Jacks V/V-EX/G/U</b>		<b>3 - 18</b>
Product description		4
Toe Jacks V5 + V10	5 t + 10 t	5 - 6
Toe Jacks V15 + V20	15 t + 20 t	7 - 8
Toe Jacks V5-EX + V10-EX	5 t + 10 t	9 - 10
Toe Jacks V15-EX + V15-EX 270	15 t	11 - 12
Toe Jacks V20-EX + V30-EX	20 t + 30 t	13 - 14
Toe Jacks G5 + G10	5 t + 10 t	15 - 16
Unilifter U6 + Jack Repair	6 t	17 - 18
<b>Hydraulic Hand Pumps PV and Electric Pumps PE</b>		<b>19 - 24</b>
Product description		20
Hydraulic Hand Pump PV + Hydraulic Electric Pump PE		21 - 22
Hydraulic Electric Pump PE 2 + PE 4		23 - 24
<b>Transport Dollies F/L/TL</b>		<b>25 - 42</b>
Product description		26
Transport Dollies F3 / L3 + F6 / L6	6 t + 12 t	27 - 28
Transport Dollies F9 / L9 + F12 / L12	18 t + 24 t	29 - 30
Transport Dollies F18 / L18 + F20 / L20	36 t + 40 t	31 - 32
Transport Dollies F30 / L30 + F40 / L40	60 t + 80 t	33 - 34
Transport Dollies F60 / L60 + Tandem Dolly TL6	120 t + 6 t	35 - 36
Tandem Dollies TL12 + TL20	12 t + 20 t	37 - 38
Tandem Dolly TL40 + Container Dollies F6-c / TL6-c	40 t + 12 t	39 - 40
Container Dollies F12-c / TL12-c + Twinlifter TW2800	24 t + 2.8 t	41 - 42
<b>Rotating Dollies RL</b>		<b>43 - 52</b>
Product description		44
Rotating Dollies RL1 + RL2	1 t + 2 t	45 - 46
Rotating Dollies RL4 + RL6	4 t + 6 t	47 - 48
Rotating Dollies RL6-D + RL8	6 t + 8 t	49 - 50
Rotating Dolly RL12 + Rotating Dolly Accessories	12 t	51 - 52





**Hydraulic Toe Jacks**

**Pgs. 03-18**

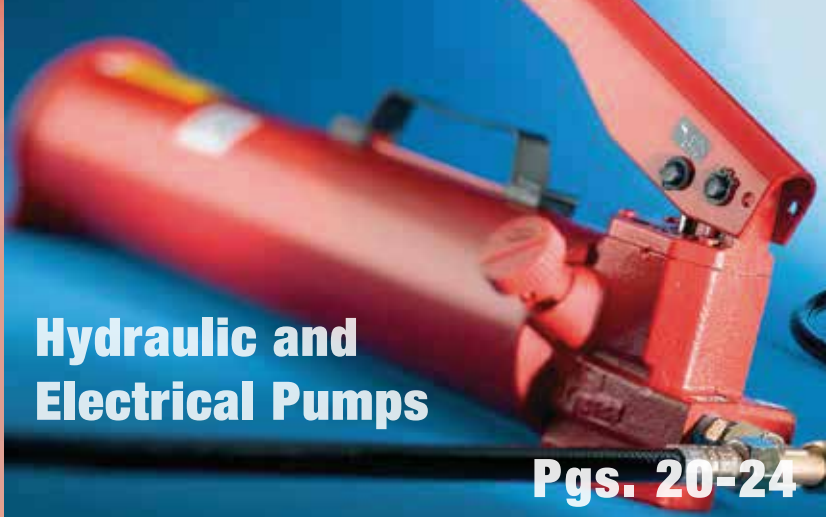

**Hydraulic and Electrical Pumps**

**Pgs. 20-24**



**Transport Dollies**

**Pgs. 25-42**



**Rotating Dollies**

**Pgs. 43-52**



**Wheels**

**Pgs. 59-62**

# **HEAVYCARGO<sup>®</sup>**

**Equipos & Herramientas muevecarga**

# Hydraulic Toe Jacks

V / V-EX / G / U



# Hydraulic Toe Jacks V/V-EX/G/U



GKS-PERFEKT hydraulic toe jacks are a specialized jack for lifting loads with low clearance, and can be used in a variety of applications. The adjustable toe and extended feet on our toe jack gives it more stability and flexibility than a standard jack. Our engineering philosophy is simple: less parts, less problems. The less moving parts there are, the less problems that will occur during the life of the product. Given all of this, along with the testing that is done on every jack before leaving our factory, our hydraulic toe jacks are not only functional, but also long-lasting—an investment that will pay over time.

## FEATURES

- Extremely low loading height, starting from 0.6 inches
- Simplified Design—less parts, less problems
- Test mark ANSI/ASME
- Height adjustable, die-forged safety toe
- Precision guideways
- Wheels for easy transport
- Lifetime technical support

## V5 Hydraulic Toe Jack

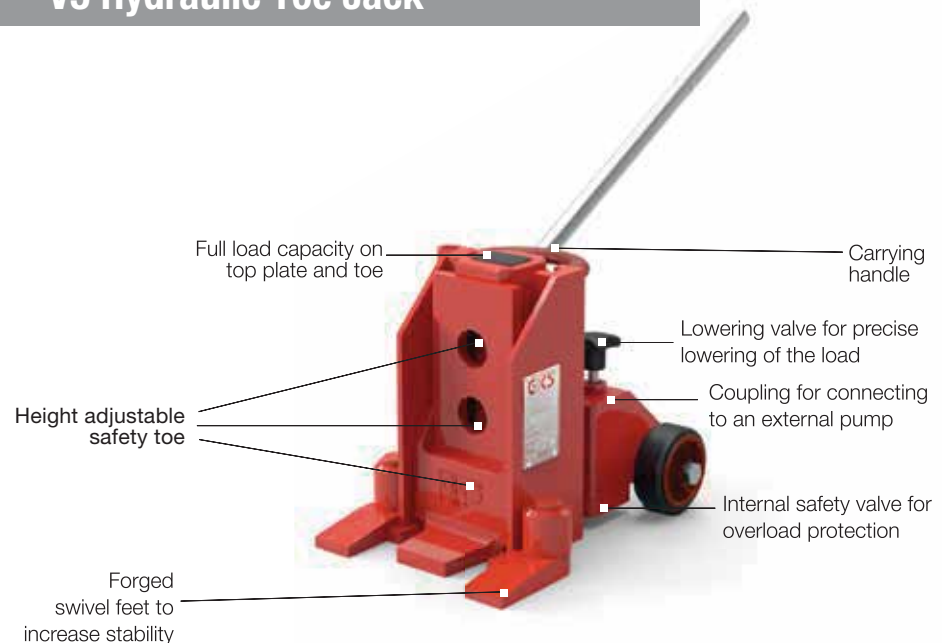





## Toe Jack V5

### Features:

- Forged, steel safety toe, which is stronger than the industry standard of cast steel
- A peg on the back of the toe that secures correct insertion
- Same loading capacity on the toe and the head
- 3 starting positions



### Technical data

	V5
Item number	1-10181
Full load capacity	11,000 lbs. / 50kN (5 t)
Working pressure	7,542 psi / 520 bar
Minimum loading height using safety toe	0.6" / 15 mm
Lifting height	5.5" / 140 mm
Adjustable range of safety toe	3 x
Loading height using top plate	10" / 252 mm
Overall dimensions (L x W x H)	11.2 x 9.3 x 10" / 285 x 235 x 252 mm
Tare weight with oil fill	46 lbs. / 21 kg

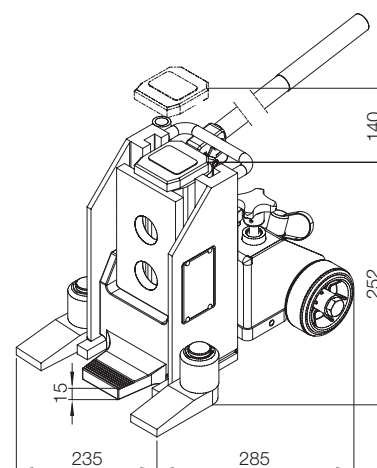



## Toe Jack V10

### Features:

- Forged, steel safety toe, which is stronger than the industry standard of cast steel
- Swivel feet to increase stability
- Same loading capacity on the toe and the head
- 4 starting positions



### Technical data

#### V10

Item number	1-10182
Full load capacity	22,000 lbs. / 100kN (10 t)
Working pressure	7,542 psi / 520 bar
Minimum loading height using safety toe	0.8" / 20 mm
Lifting height	6.3" / 160 mm
Adjustable range of safety toe	4 x
Loading height using top plate	12.2" / 310 mm
Overall dimensions (L x W x H)	14 x 10.2 x 12.2" / 357 x 260 x 310 mm
Tare weight with oil fill	71 lbs. / 32 kg

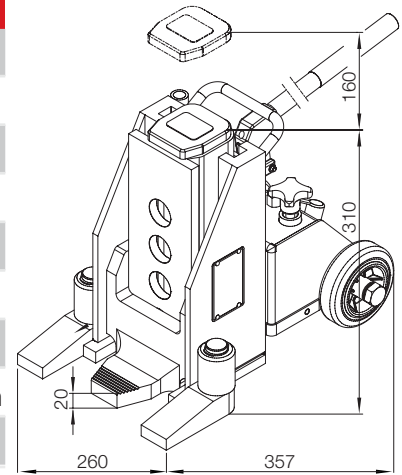



## Toe Jack V15

### Features:

- Forged, steel safety toe, which is stronger than the industry standard of cast steel
- Ability to operate manually or with a hydraulic pump
- Same loading capacity on the toe and the head
- 4 starting positions



### Technical data

### V15

Item number	1-10183
Full load capacity	33,000 lbs. / 150kN (10 t)
Working pressure	7,542 psi / 520 bar
Minimum loading height using safety toe	1" / 25 mm
Lifting height	6.3" / 160 mm
Adjustable range of safety toe	4 x
Loading height using top plate	12.5" / 318 mm
Overall dimensions (L x W x H)	15.7 x 12.6 x 12.5" / 399 x 320 x 318 mm
Tare weight with oil fill	117 lbs. / 53 kg

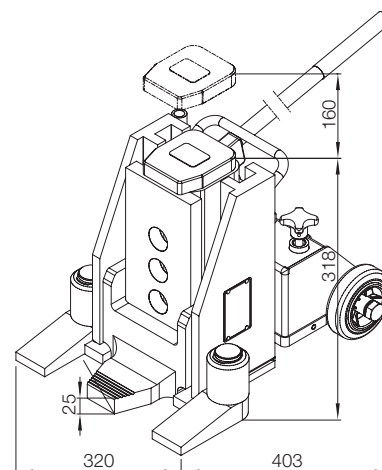





## Toe Jack V20

### Features:

- Forged, steel safety toe, which is stronger than the industry standard of cast steel
- Fast stroke and slow stroke cylinders to facilitate manual lifting operation
- Ability to operate manually or with a hydraulic pump
- 3 starting positions



### Technical data

#### V20

Item number	1-10184
Full load capacity	44,000 lbs. / 200kN (20 t)
Working pressure	7,542 psi / 520 bar
Minimum loading height using safety toe	1.2" / 30 mm
Lifting height	6.3" / 160 mm
Adjustable range of safety toe	3 x
Loading height using top plate	12.8" / 325 mm
Overall dimensions (L x W x H)	16.7 x 12.8 x 12.8" / 425 x 326 x 325 mm
Tare weight with oil fill	159 lbs. / 72 kg

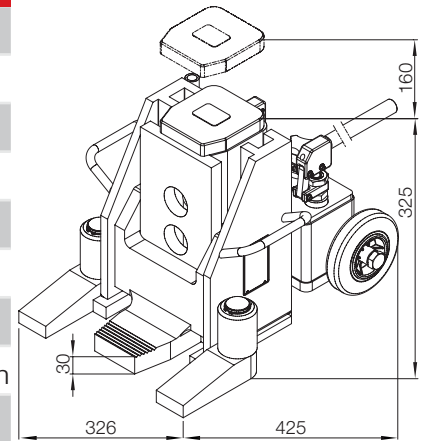

Contents

Hydraulic  
Toe Jacks

Pumps

Transport Dollies

Rotating Dollies

ROBOTS

Wheels

Nickel  
Plated Equipment



## Toe Jack V5-EX

### Features:

- Without internal hydraulics to minimize weight and size
- Designed for applications with difficult to access spaces or where a safety distance from the load is required
- Same loading capacity on the toe and the head
- 3 starting positions



### Technical data

### V5-EX

Item number	1-10185
Full load capacity	11,000 lbs. / 50kN (5 t)
Working pressure	7,542 psi / 520 bar
Minimum loading height using safety toe	0.6" / 15 mm
Lifting height	5.5" / 140 mm
Adjustable range of safety toe	3 x
Loading height using top plate	10" / 252 mm
Overall dimensions (L x W x H)	8.9x8.3 x 10" / 227 x 212 x 252 mm
Tare weight	38 lbs. / 17 kg

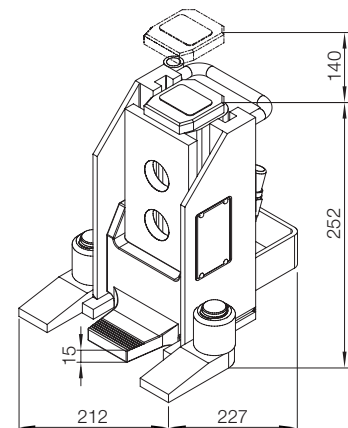



## Toe Jack V10-EX

- Features:**
- Lack of internal hydraulics—to minimize weight and size
  - Meant for applications with difficult to access spaces or where a safety distance from the load is required
  - Swivel feet to increase stability
  - 4 starting positions



Technical data	V10-EX
Item number	1-10186
Full load capacity	22,000 lbs. / 100kN (5 t)
Working pressure	7,542 psi / 520 bar
Minimum loading height using safety toe	0.8" / 20 mm
Lifting height	6.3" / 160 mm
Adjustable range of safety toe	4 x
Loading height using top plate	12.2" / 310 mm
Overall dimensions (L x W x H)	11 x 9.3 x 12.2" / 280 x 237 x 310 mm
Tare weight	57 lbs. / 26 kg

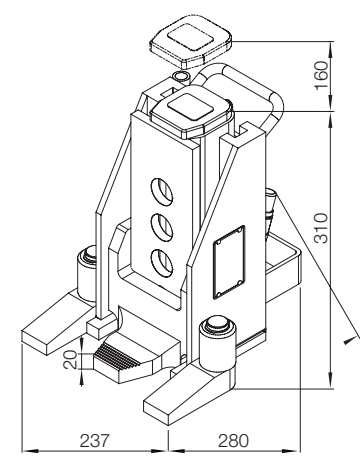

- Contents
- Hydraulic Toe Jacks
- Pumps
- Transport Dollies
- Rotating Dollies
- ROBOTS
- Wheels
- Nickel Plated Equipment



## Toe Jack V15-EX

### Features:

- No internal hydraulics to reduce the weight and size of the jack
- Designed for applications with difficult to access spaces or where a safety distance from the load is required
- Forged, steel safety toe, which is stronger than the industry standard of cast steel
- 4 starting positions



Technical data	V15-EX
Item number	1-10527
Full load capacity	33,000 lbs. / 150kN (15 t)
Working pressure	7,542 psi / 520 bar
Minimum loading height using safety toe	1" / 25 mm
Lifting height	6.3" / 160 mm
Adjustable range of safety toe	4 x
Loading height using top plate	12.2" / 310 mm
Overall dimensions (L x W x H)	13.7 x 12 x 12.5" / 350 x 304 x 318 mm
Tare weight	94 lbs. / 43 kg

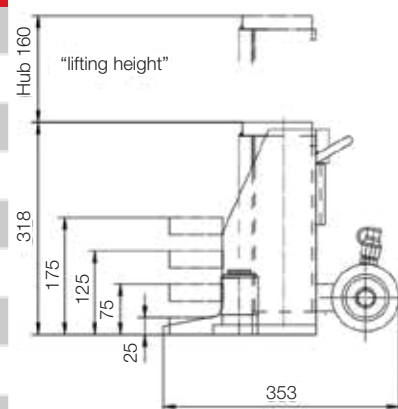



## Toe Jack V15-EX 270

### Features:

- A higher stroke jack designed for higher lifting applications, like the ROBOT 40, without having to 'block'
- Electric pump must be used for operation
- Forged, steel safety toe, which is stronger than the industry standard of cast steel
- 2 starting positions



### Technical data

#### V15-EX 270

Item number	1-14022
Full load capacity	33,000 lbs. / 150kN (15 t)
Working pressure	7,542 psi / 520 bar
Minimum loading height using safety toe	2.2" / 55 mm
Lifting height	10.6" / 270 mm
Adjustable range of safety toe	2 x
Loading height using top plate	20.4" / 518 mm
Overall dimensions (L x W x H)	20.4 x 16.5 x 12.4" / 518 x 420 x 314 mm
Tare weight	185.2 lbs. / 84 kg

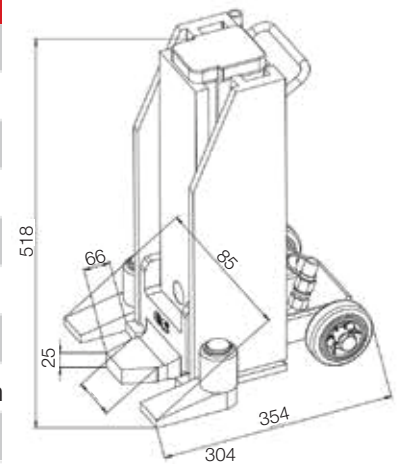



## Toe Jack V20-EX

### Features:

- No internal hydraulics to reduce the weight and size of the jack
- Designed for applications with difficult to access spaces or where a safety distance from the load is required
- Forged, steel safety toe, which is stronger than the industry standard of cast steel
- 3 starting positions



Technical data	V20-EX
Item number	1-11141
Full load capacity	44,000 lbs. / 200 kN (20 t)
Working pressure	7,542 psi / 520 bar
Minimum loading height using safety toe	1.2" / 30 mm
Lifting height	6.3" / 160 mm
Adjustable range of safety toe	3 x
Loading height using top plate	12.8" / 325 mm
Overall dimensions (L x W x H)	16.7 x 12.8 x 12.8" / 425 x 325 x 325 mm
Tare weight	155 lbs. / 71 kg

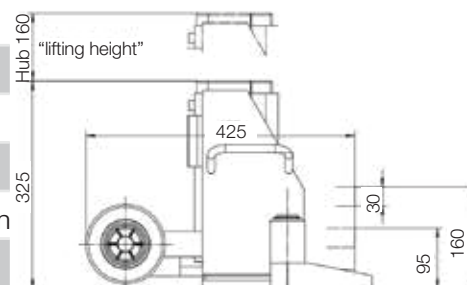





## Toe Jack V30-EX

### Features:

- Built without internal hydraulics to reduce the weight and size of the jack
- Designed for applications with difficult to access spaces or where a safety distance from the load is required
- Same loading capacity on the toe and the head
- 2 starting positions



### Technical data

### V30-EX

Item number	1-11140
Full load capacity	66,000 lbs. / 300 kN (30 t)
Working pressure	6,237 psi / 430 bar
Minimum loading height using safety toe	1.6" / 40 mm
Lifting height	6.1" / 156 mm
Adjustable range of safety toe	2 x
Loading height using top plate	13" / 330 mm
Overall dimensions (L x W x H)	17.9x 15.7 x 13" / 454 x 400 x 330 mm
Tare weight	232 lbs. / 105 kg

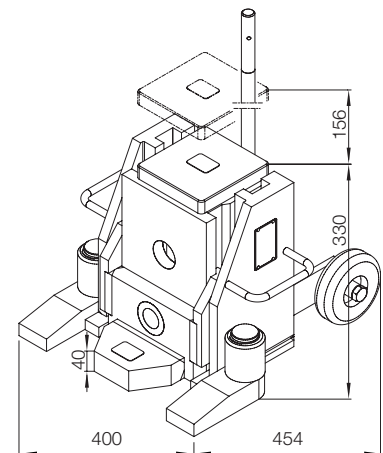



**Toe Jack G5**

- Features:**
- Specially designed for maintenance purposes on fork lift trucks and other industrial vehicles
  - Outstanding stability due to solid feet and an extended grooved safety toe
  - 3 starting positions



Technical data	G5
Item number	1-10189
Full load capacity	11,000 lbs. / 50 kN (5 t)
Working pressure	7,542 psi / 520 bar
Minimum loading height using safety toe	1.2" / 30 mm
Lifting height	5.5" / 140 mm
Adjustable range of safety toe	3 x
Loading height using top plate	10.4" / 265 mm
Overall dimensions (L x W x H)	15.6x10 x 10.4" / 397 x 255 x 265 mm
Tare weight with oil fill	66 lbs. / 30 kg

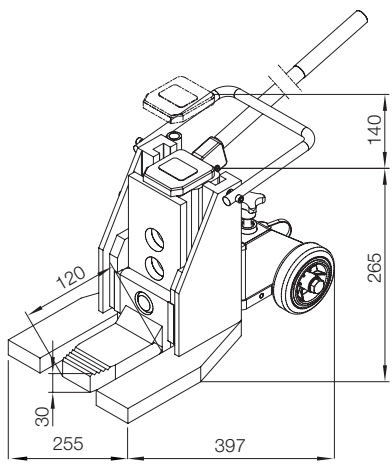



## Toe Jack G10

### Features:

- Specially designed for maintenance purposes on fork lift trucks and other industrial vehicles
- Outstanding stability due to solid feet and an extended grooved safety toe
- 3 starting positions



### Technical data

#### G10

Item number	1-12378
Full load capacity	22,000 lbs. / 100 kN (10 t)
Working pressure	7,542 psi / 520 bar
Minimum loading height using safety toe	1.4" / 35 mm
Lifting height	5.5" / 140 mm
Adjustable range of safety toe	3 x
Loading height using top plate	12.5" / 318 mm
Overall dimensions (L x W x H)	18.1 x 11 x 12.5" / 461 x 280 x 318 mm
Tare weight with oil fill	127 lbs. / 57 kg

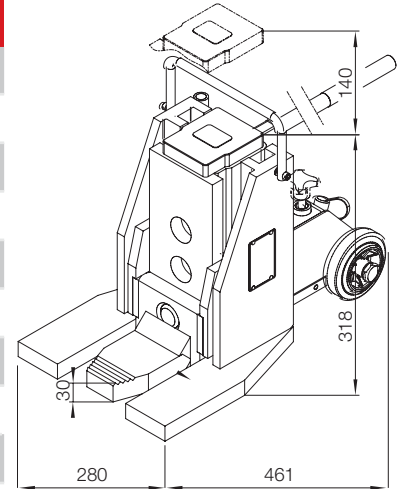



## Unilifter U6

### Features:

- Vertical use- works as a standard hydraulic toe jack
- Horizontal use- can jack machines away from walls
- An all-purpose, lightweight jack



Technical data	U6
Item number	1-13292
Full load capacity	13,000 lbs. / 60 kN (6 t)
Working pressure	7,542 psi / 520 bar
Minimum loading height using safety toe	0.7" / 18 mm
Lifting height	4.5" / 115 mm
Adjustable range of safety toe	-
Loading height using top plate	10.4" / 265 mm
Overall dimensions (L x W x H)	12 x 5.7 x 10.4" / 306 x 146 x 265 mm
Tare weight with oil fill	33 lbs. / 15 kg

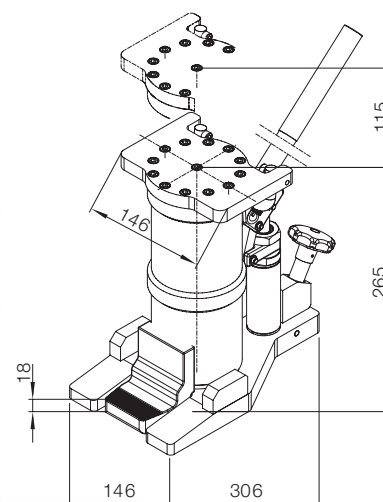



## Repair

It is of the utmost importance that your hydraulic toe jack is performing to the best of its ability. We believe in selling long lasting products, but just like any car, it helps to get a check-up. That's why we offer jack repair services, so that your jacks continue to perform up to the standard you expect from GKS-PERFEKT.

Send us your jack and we'll do a tune-up for that big job that's coming up. We've got certified repair on the east and west coast that will make your jack as good as new!

Once we evaluate the jack, we'll send you a quote for the work and make sure that you're ok with the repairs getting completed.

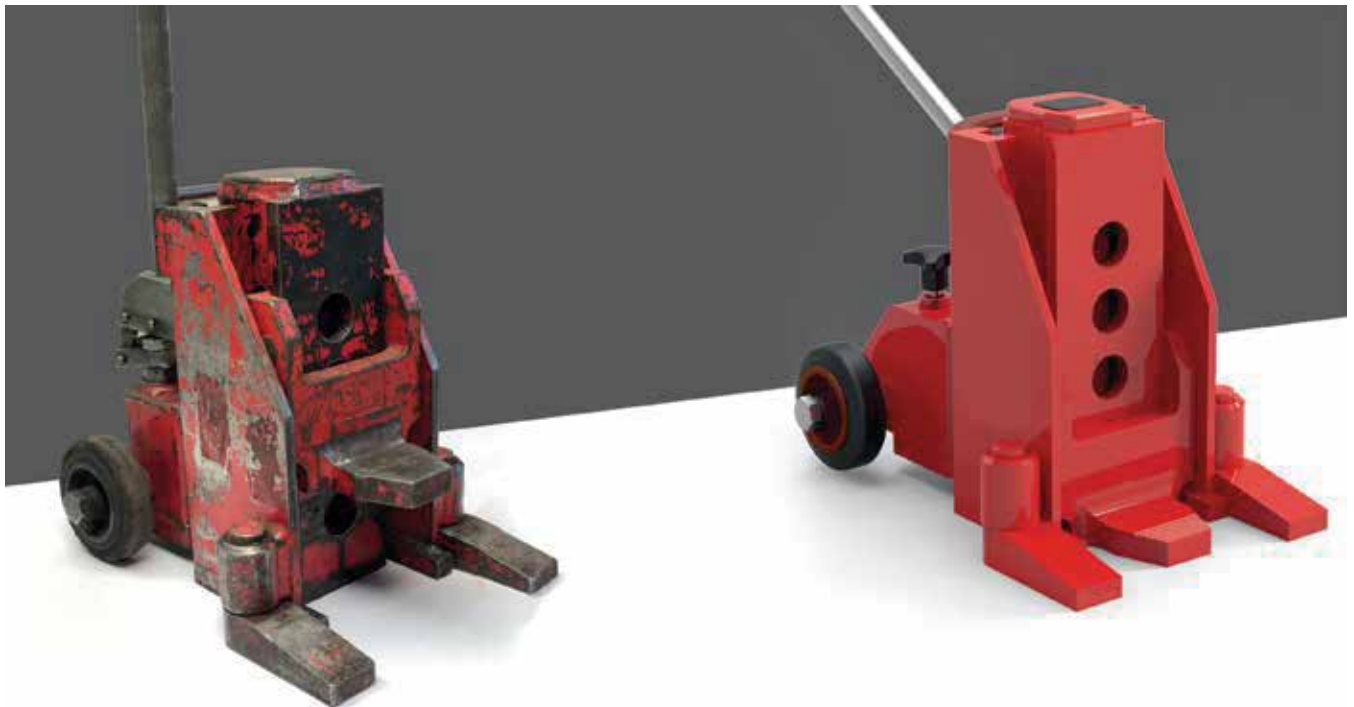

**Before**

**After**

Contents

Hydraulic  
Toe Jacks

Pumps

Transport Dollies

Rotating Dollies

ROBOTS

Wheels

Nickel  
Plated Equipment



# Hydraulic Hand Pumps PV and Electric Pumps PE

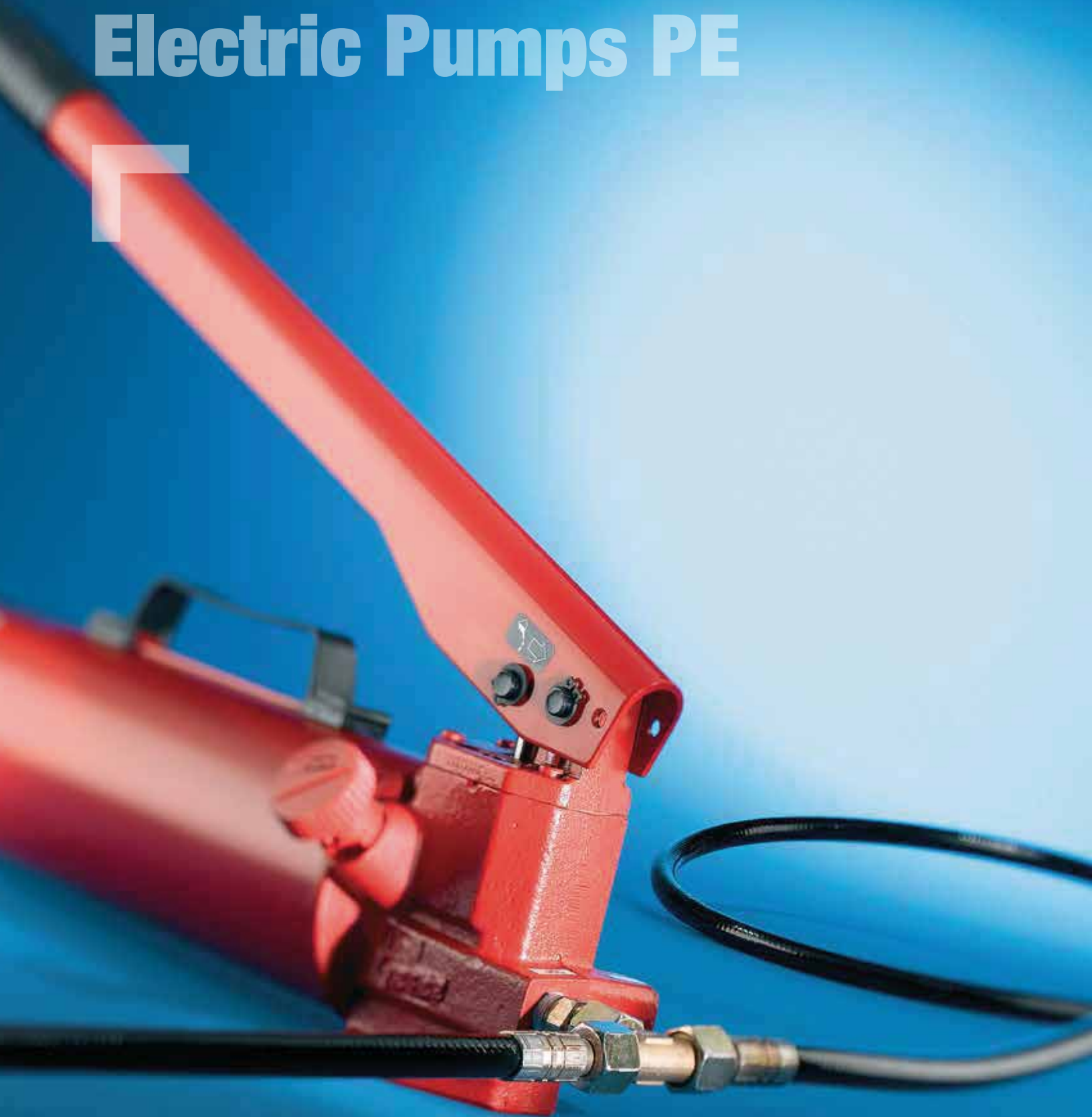



# Hydraulic Hand Pumps PV and Electric Pumps PE



Our GKS pumps allow for increased efficiency and safety in your daily operation. Our hand and electric pumps help you operate our jacks quicker and allows for users to lift multiple jacks simultaneously, saving you time. Pumps allow you to lift the load while keeping a far distance—increasing user safety.

## Hand Pump PV



## Electric Pump PE

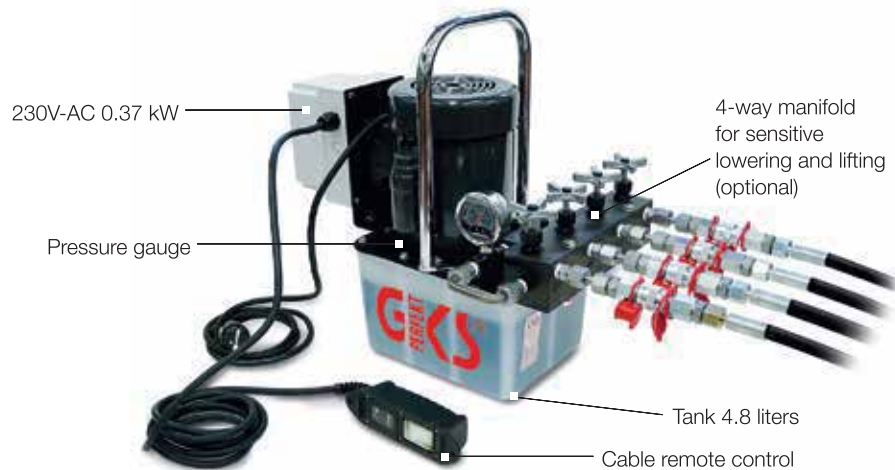



## Hydraulic Hand Pumps PV

### Features:

- Reduce operating time and increase the safety factor through the use of a pump
- Options: Gauge, shut-off needle valve, extended hydraulic hoses



Technical data	PV
Item number	2-10198
Working pressure (preset)	7,542psi / 520 bar
Flow rate stage 1 per lift	2.6 cu. in / 435 psi / 42 cm <sup>3</sup> / 30 bar
Flow rate stage 2 per lift	0.16 cu. in / 7,542 psi / 2,6 cm <sup>3</sup> / 520 bar
Tank capacity	0.6 gal / 2,25 l
Overall dimensions (L x W x H)	18.3x5.6x6.9" / 465 x 143 x 175 mm
Tare weight incl. oil fill (without hoses)	27 lbs. / 12 kg (incl. Oil fill)
Hydraulic hoses (2 m) - with quick-release fastener	2 hoses
For GKS toe jack models	2 x V5, V5-EX, V10, V10-EX, V15, V15-EX, G5

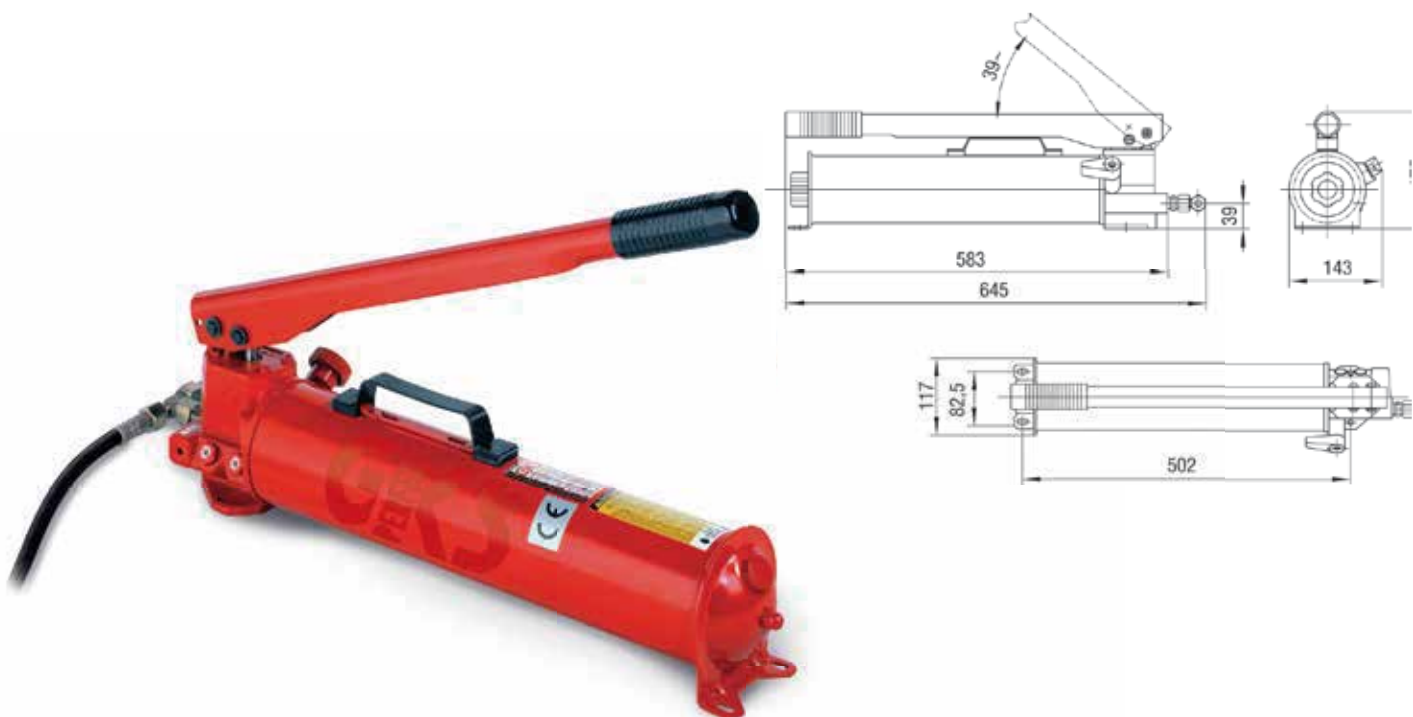



## Hydraulic Electric Pump PE

### Features:

- Reduce operating time and increase the safety factor through the use of a pump
- Standard model including remote control, pressure gauge, 2/2 directional control valves for single-acting cylinders and 2 x 3 m hydraulic hoses with non-drip quick-release fasteners on both sides



### Technical data

### PE

Item number	2-10199
Working pressure (preset)	7,542psi / 520 bar
Flow rate stage 1 per lift	0.67 gal/min @ 102 psi 2,5 ltr/min @ 7 bar
Flow rate stage 2 per lift	0.08 gal/min @ 7,542 psi 0,3 ltr/min @ 520 bar
Tank capacity	1.27 gal / 4,8 l
Overall dimensions (L x W x H)	17.7 x 12.2 x 17.7" / 450 x 310 x 450 mm
Tare weight incl. oil fill (without hoses)	66 lbs. / 30 kg
Hydraulic hoses (10" / 3 m), - with quick-release fastener	2 hoses
For GKS toe jack models	2x V5, V5-EX, V10, V10-EX, V15, V15-EX, V15-EX-270, V20, V20-EX, V30-EX, G5, G10
Electric connection	120V/60 Hz

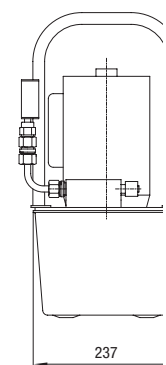
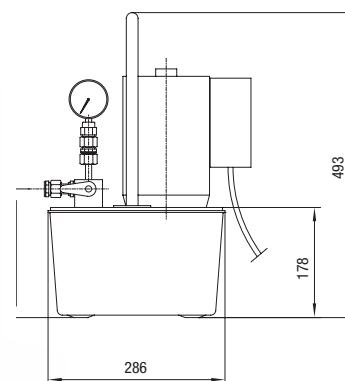
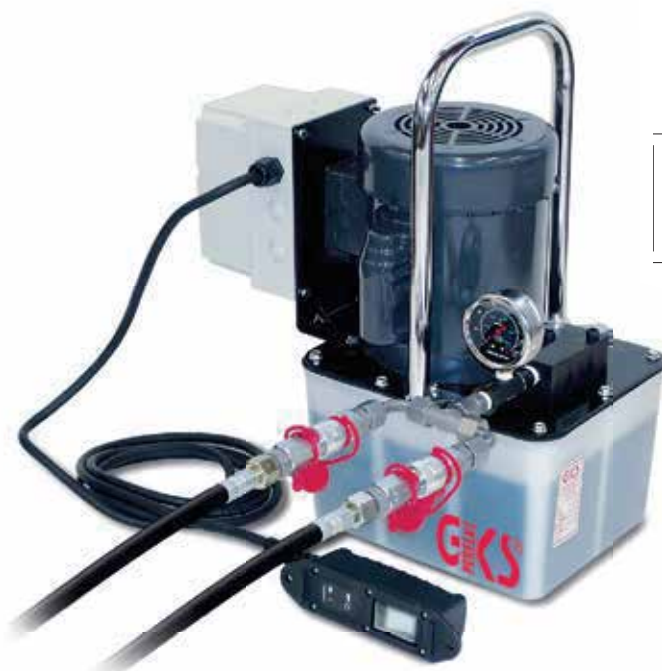

Contents

Hydraulic  
Toe Jacks

Pumps

Transport Dollies

Rotating Dollies

ROBOTS

Wheels

Nickel  
Plated Equipment



## Hydraulic Electric Pump PE2

### Features:

- Like PE, but with added 2-way manifold including 2 male couplings and 2 needle valves for sensitive lifting and lowering.



### Technical data

	PE2
Item number	2-13591
Working pressure (preset)	7,542psi / 520 bar
Flow rate stage 1 per lift	0.67 gal/min @ 102 psi 2,5 ltr/min @ 7 bar
Flow rate stage 2 per lift	0.08 gal/min @ 7,542 psi 0,3 ltr/min @ 520 bar
Tank capacity	1.27 gal / 4,8 l
Overall dimensions (L x W x H)	25.6x 12.2x 19.5" / 650 x 310 x 495 mm
Tare weight incl. oil fill (without hoses)	77 lbs. / 35 kg
Hydraulic hoses (10 " / 3 m), - with quick-release fastener	2 hoses
For GKS toe jack models	2x V5, V5-EX, V10, V10-EX, V15, V15-EX, V15-EX-270, V20, V20-EX, V30-EX, G5, G10
Electric connection	120V/60 Hz

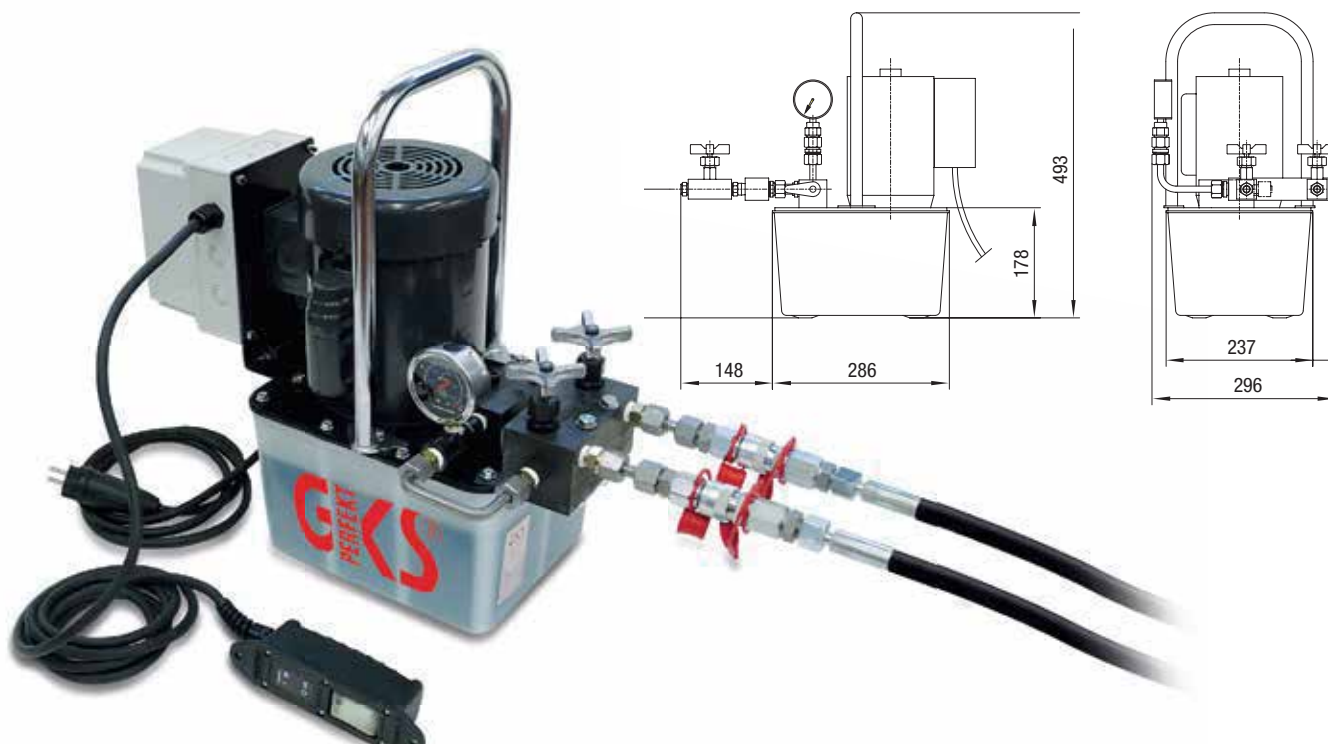





## Electric Pump PE4

### Features:

- Like PE2, but with 4-way manifold and 4 x 3 m hoses.
- Operate up to 4 jacks at once.



### Technical data

### PE4

Item number	2-13592
Working pressure (preset)	7,542psi / 520 bar
Flow rate stage 1 per lift	0.67 gal/min @ 102 psi 2,5 ltr/min @ 7 bar
Flow rate stage 2 per lift	0.08 gal/min @ 7,542 psi 0,3 ltr/min @ 520 bar
Tank capacity	1.27 gal / 4,8 l
Overall dimensions (L x W x H)	25.6x12.2x19.5" / 650 x 310 x 495 mm
Tare weight incl. oil fill (without hoses)	97 lbs. / 44 kg
Hydraulic hoses (10" / 3 m), - with quick-release fastener	4 hoses
For GKS toe jack models	4x V5, V5-EX, V10, V10-EX, V15, V15-EX, V15-EX-270, V20, V20-EX, G5, G10, 2x V30-EX
Electric connection	120 V/60 Hz

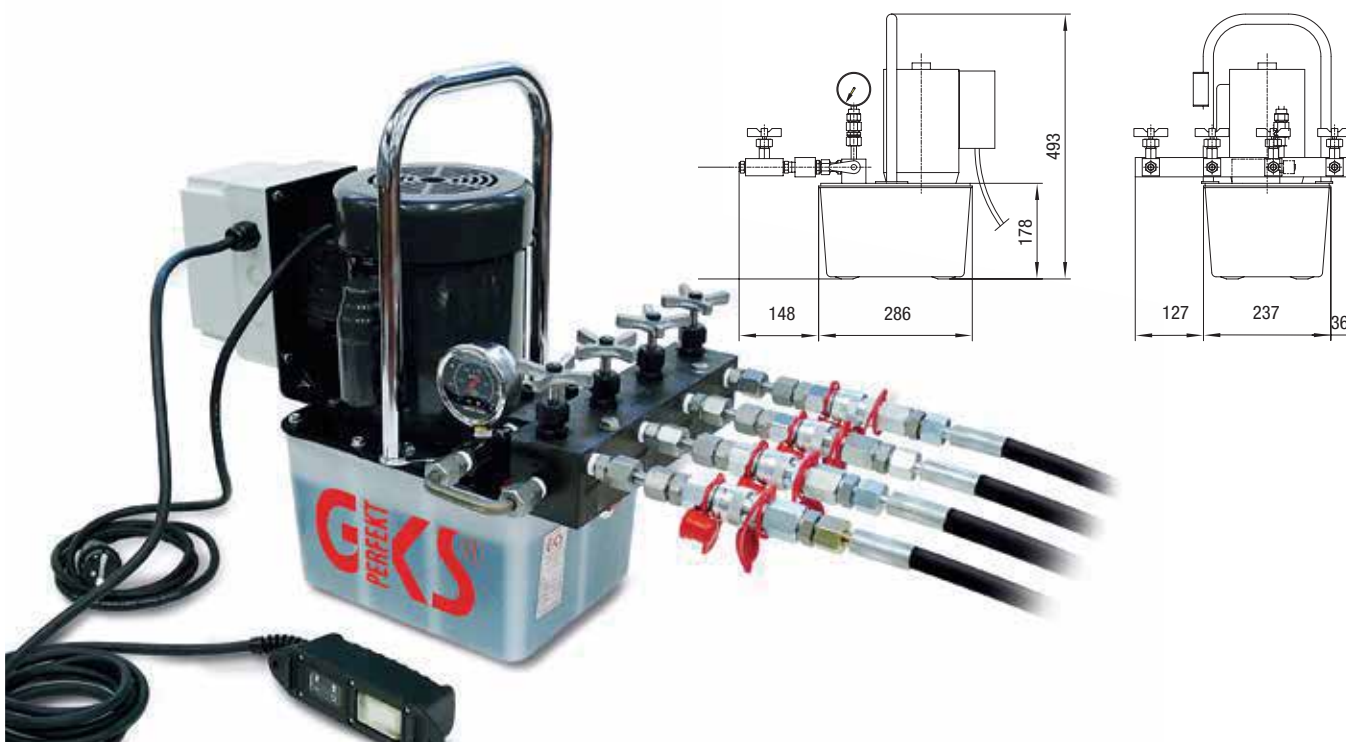

Contents

Hydraulic  
Toe Jacks

Pumps

Transport Dollies

Rotating Dollies

ROBOTS

Wheels

Nickel  
Plated Equipment

# Transport Dollies

F / L / TL

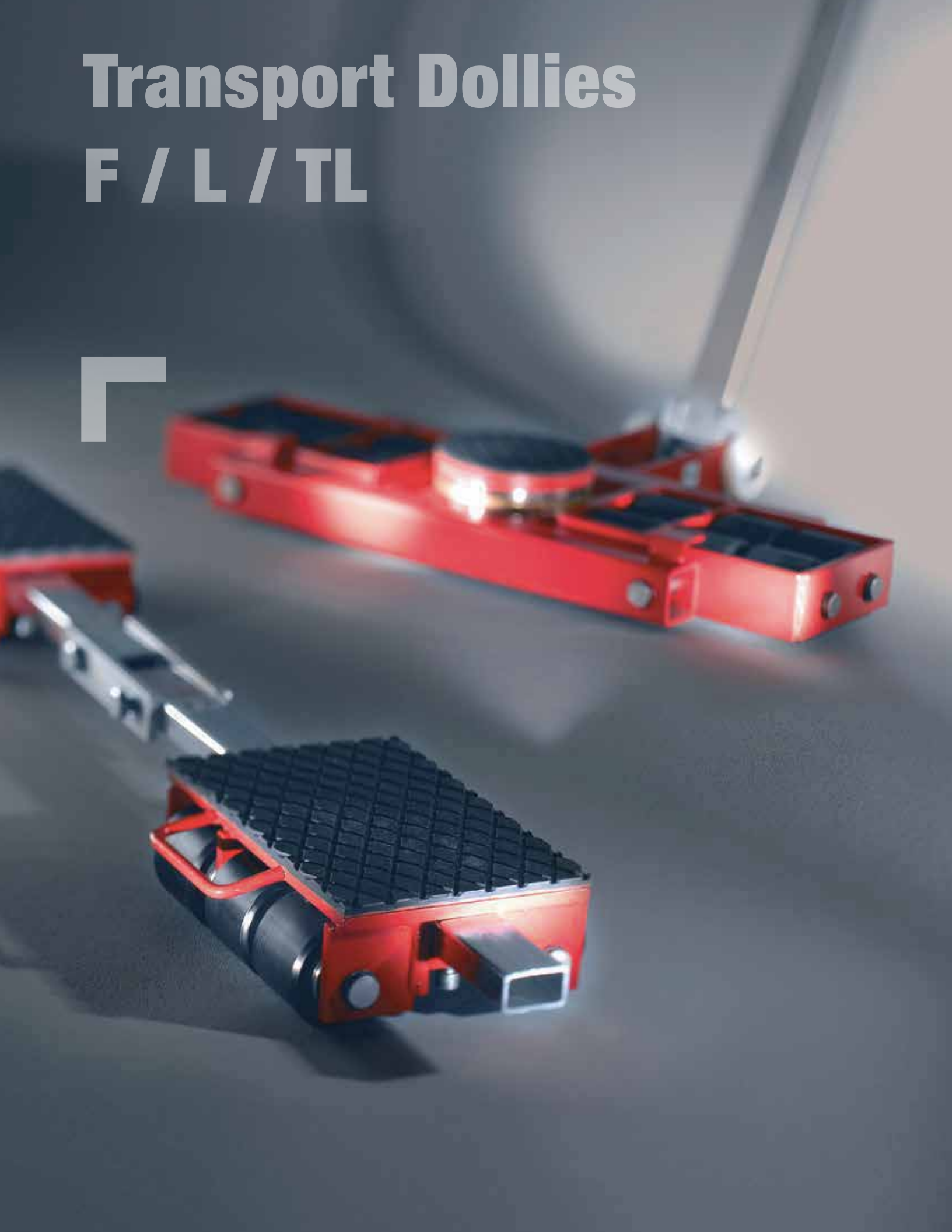



# Transport Dollies

## F / L / TL



When it comes to transporting heavy loads, GKS-PERFEKT transport dollies have proven themselves for over 50 years. Our traditional set, consisting of a steerable lead dolly ('L dolly') and a following dolly ('F dolly'), offers 3 points of support and works in most moving situations. For uneven loads, we recommend pairing our traditional 'F dolly' with a tandem lead dolly ('TL dolly') to create a 4-point system. GKS-PERFEKT also has specialty dollies to help move ISO containers (container dollies with special locks) and irregular, bulky loads (twinlifter dolly with hydraulic capabilities).

### Leading Dolly L9

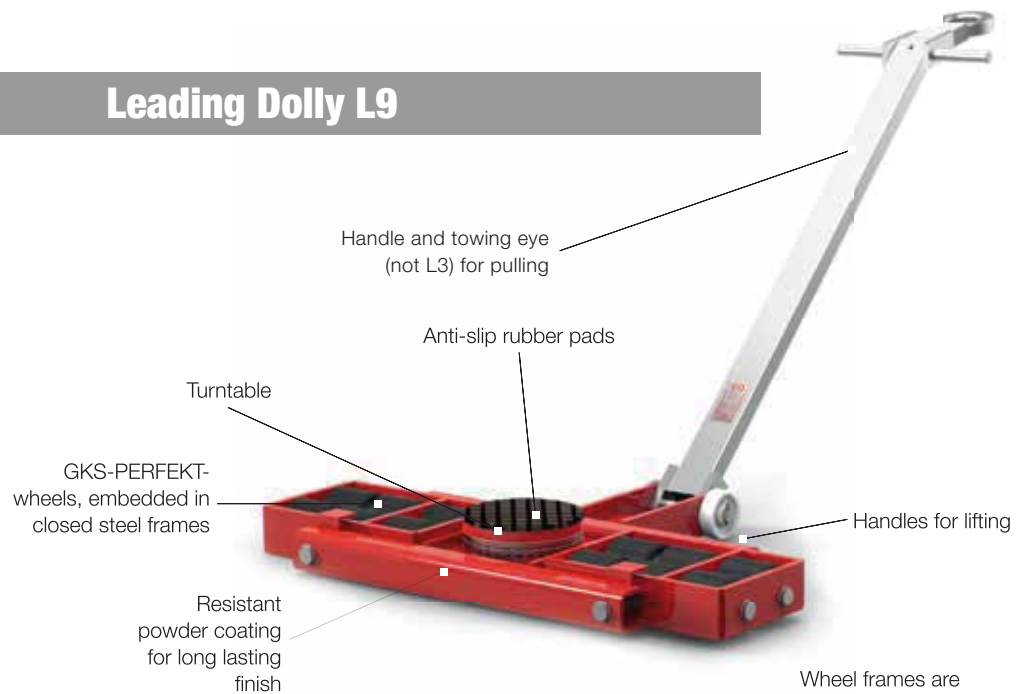

Wheel frames are embedded with oscillating axles, to compensate for uneven floors (not L3)

### Following Dolly F9



Contents

Hydraulic  
Toe Jacks

Pumps

Transport Dollies

Rotating Dollies

ROBOTS

Wheels

Nickel  
Plated Equipment



## Transport Dollies F3 / L3

### Features:

- L dolly- swivel plate to facilitate steering
- F dolly- width adjustable points of contact
- Durable, non-marking rollers
- Thick, grooved rubber pads to prevent load slippage

Technical data	F3	L3
Item number	3-10206	3-10207
Loading height / number of wheels (85 x 85 mm)	4.3" / 4 110mm / 4	4.3" / 4 110mm / 4
Contact surface per cartridge	5.9x5.9" / 150 x 150 mm	—
Connecting bar	11.8-39.4" / 300 - 1000 mm	—
Swivel plate ø 170 mm, steering angle	—	±90°
Steering rod	—	37.4" / 950 mm
Overall dimensions (L x W)	—	10.6 x 9.1" / 270 x 230 mm
Tare weight	33 lbs. / 15 kg	27 lbs. / 15 kg
Load Capacity	6,600 lbs. / 30 kN (3 t)	6,600 lbs. / 30 kN (3 t)
Total load capacity	13,200 lbs. / 60 kN (6 t)	

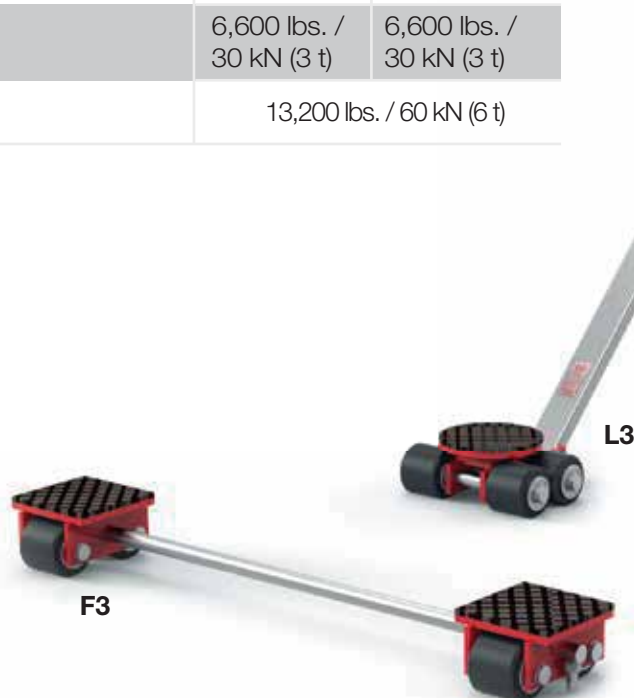
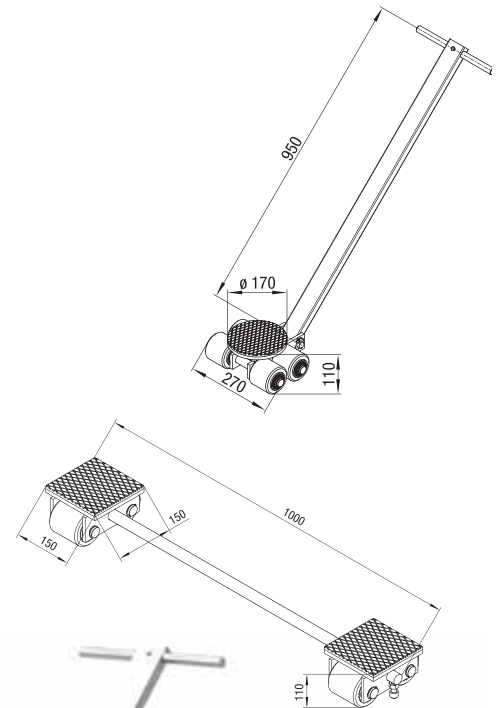



## Transport Dollies F6 / L6

- Features:**
- L dolly- includes towing eye for easy transport of the load
  - F dolly- connecting bar with joint to accommodate uneven surfaces
  - High durability wheels that are non-marking
  - All wheels are boxed in for protection



Technical data	F6	L6
Item number	3-10208	3-10209
Loading height / number of wheels (85 x 85 mm)	4.3" / 8 110mm / 8	4.3" / 8 110mm / 8
Contact surface per cartridge	7.9x8.7" / 200 x 220 mm	-
Connecting bar	25.2 - 40.6" / 640 x 1030 mm	-
Swivel plate $\varnothing$ 170 mm, steering angle	-	$\pm 90^\circ$
Steering rod	-	37.4" / 950 mm
Overall dimensions (L x W)	-	10.6 x 9.1" / 270 x 230 mm
Tare weight	60 lbs./30 kg	60 lbs./30 kg
Load Capacity	13,200 lbs. / 60 kN (6 t)	13,200 lbs. / 60 kN (6 t)
Total load capacity	26,400 lbs. / 120 kN (12 t)	

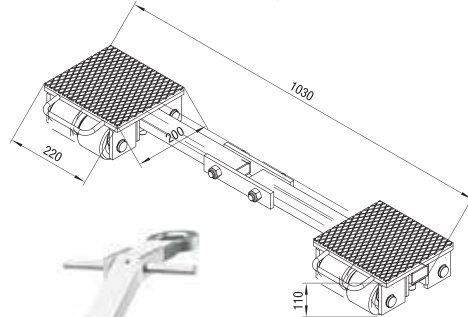
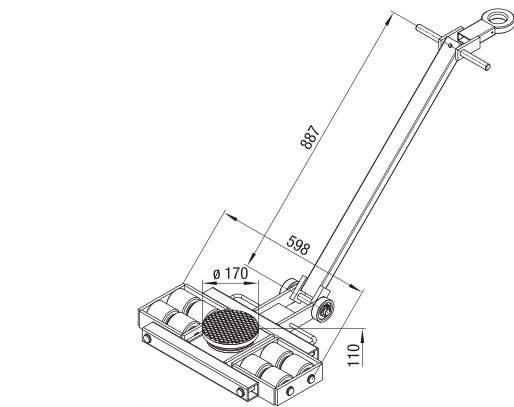

- Contents
- Hydraulic Toe Jacks
- Pumps
- Transport Dollies
- Rotating Dollies
- ROBOTS
- Wheels
- Nickel Plated Equipment



## Transport Dollies F9 / L9

### Features:

- L dolly- swivel plate to facilitate steering
- F dolly- connecting bar with joint to accommodate uneven surfaces
- Durable, non-marking rollers
- Thick, grooved rubber pads to prevent load slippage

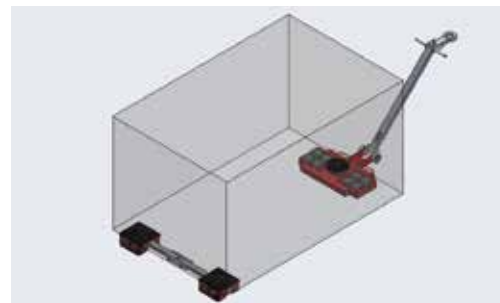

Technical data	F9	L9
Item number	3-11070	3-11071
Loading height / number of wheels (85 x 85 mm)	4.3" / 12 110mm / 8	4.3" / 12 110mm / 8
Contact surface per cartridge	12.6x7.9" / 320 x 200 mm	–
Connecting bar	33 - 48.4" / 840 x 1230 mm	–
Swivel plate $\varnothing$ 170 mm, steering angle	–	$\pm 90^\circ$
Steering rod	–	37.4" / 950 mm
Overall dimensions (L x W)	–	33.1 x 23" / 840 x 583 mm
Tare weight	95 lbs./43 kg	130 lbs./59 kg
Load Capacity	19,800 lbs. / 90 kN (9 t)	19,800 lbs. / 90 kN (9 t)
Total load capacity	39,600 lbs. / 180 kN (18 t)	

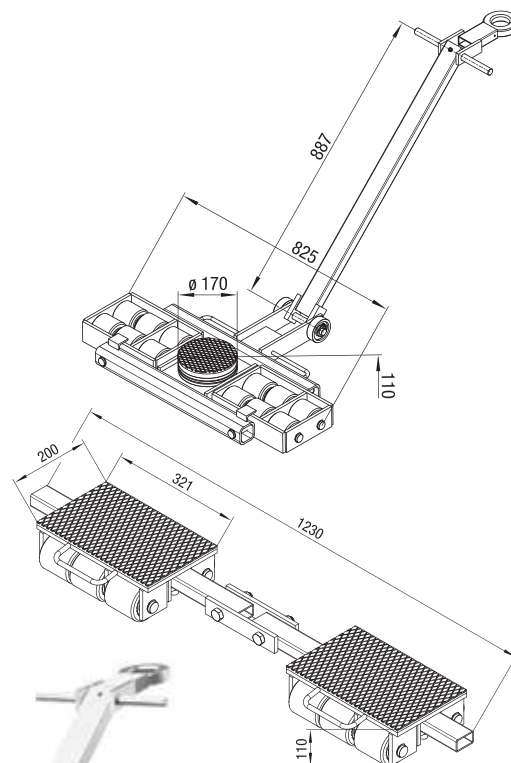





## Transport Dollies F12 / L12

- Features:**
- L dolly- includes towing eye for easy transport of the load
  - F dolly- connecting bar with joint to accommodate uneven surfaces
  - High durability wheels that are non-marking
  - All wheels are boxed in for protection

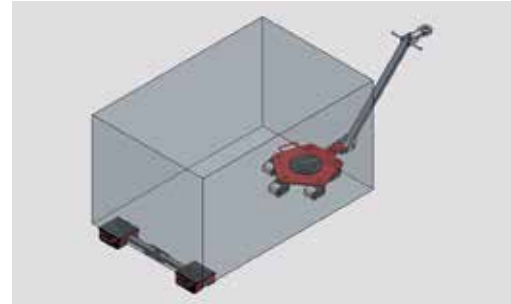

Technical data	F12	L12
Item number	3-10312	3-10313
Loading height / number of wheels (85 x 85 mm)	4.3" / 16 110mm / 16	4.3" / 16 110mm / 16
Contact surface per cartridge	7.6x16" / 200 x 407 mm	—
Connecting bar	39.9 -56.3" / 1014 x 1430 mm	—
Swivel plate ø 170 mm, steering angle	—	±90°
Steering rod	—	42.5"/1080mm
Overall dimensions (L x W)	—	40.6 x 24.4"/ 1030x620mm
Tare weight	115 lbs./ 52 kg	176 lbs./ 80 kg
Load Capacity	26,400 lbs. / 120 kN (12 t)	26,400 lbs. / 120 kN (12 t)
Total load capacity	52,800 lbs. / 240 kN (24 t)	

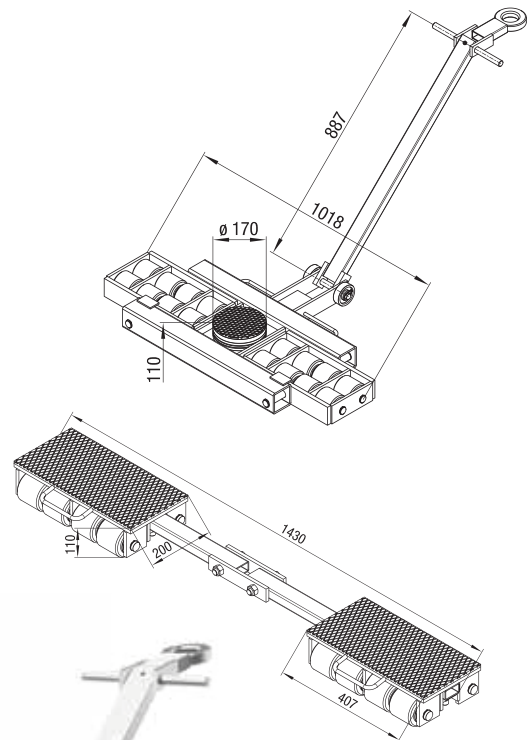

- Contents
- Hydraulic Toe Jacks
- Pumps
- Transport Dollies
- Rotating Dollies
- ROBOTS
- Wheels
- Nickel Plated Equipment



## Transport Dollies F18 / L18

### Features:

- L dolly- swivel plate to facilitate steering
- F dolly- width adjustable points of contact
- Durable, non-marking rollers
- Thick, grooved rubber pads to prevent load slippage

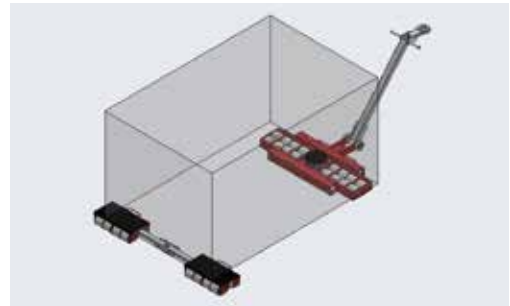

Technical data	F18	L18
Item number	3-10215	3-10216
Loading height / number of wheels (85 x 85 mm)	4.3" / 16 110mm / 16	4.3" / 16 110mm / 16
Contact surface per cartridge	7.9x16" / 200 x 407 mm	—
Connecting bar	39.9 - 56.3" / 1014 x 1430 mm	—
Swivel plate $\varnothing$ 170 mm, steering angle	—	$\pm 90^\circ$
Steering rod	—	42.5" / 1080 mm
Overall dimensions (L x W)	—	40.6 x 24.4" / 1030 x 620 mm
Tare weight	121 lbs. / 55 kg	121 lbs. / 55 kg
Load Capacity	39,500 lbs. / 180 kN (18 t)	39,500 lbs. / 180 kN (18 t)
Total load capacity	79,200 lbs. / 360 kN (36 t)	

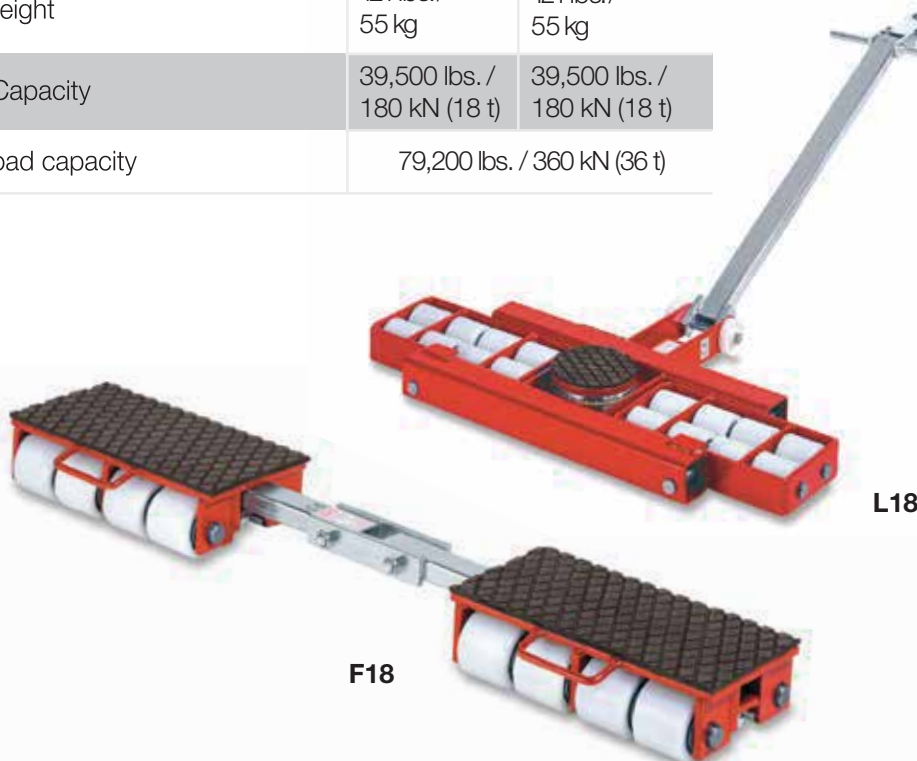
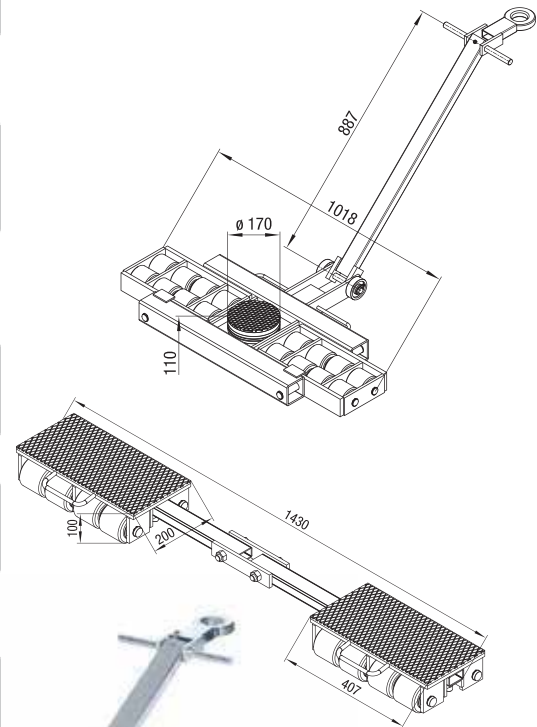



## Transport Dollies F20 / L20

- Features:**
- L dolly- includes towing eye for easy transport of the load
  - F dolly- width adjustable points of contact
  - High durability wheels that are non-marking
  - All wheels are boxed in for protection

Technical data	F20	L20
Item number	3-11060	3-11061
Loading height / number of wheels (140 x 85mm)	7.1" / 8 180 mm / 8	7.1" / 8 180 mm / 8
Contact surface per cartridge	11.2x8.7" / 280 x 220 mm	—
Connecting bar	17.3 - 63" / 440 x 1600 mm	—
Swivel plate ø 170 mm, steering angle	—	±90°
Steering rod	—	63.8"/1620mm
Overall dimensions (L x W)	—	29.4 x 31.5" / 747 x 800 mm
Tare weight	179 lbs. / 81 kg	375 lbs. / 170 kg
Load Capacity	44,000 lbs. / 200 kN (20 t)	44,000 lbs. / 200 kN (20 t)
Total load capacity	88,000 lbs. / 400 kN (40 t)	

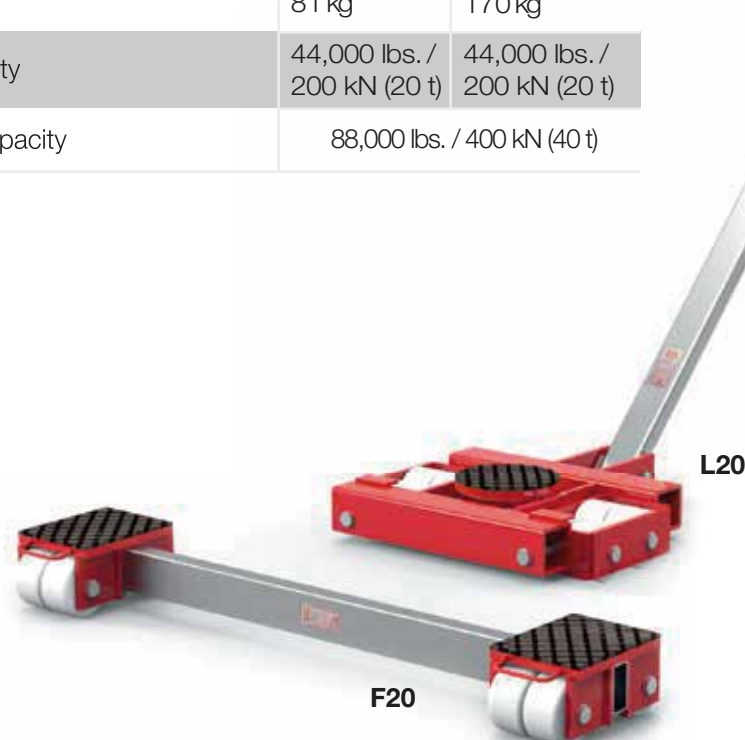
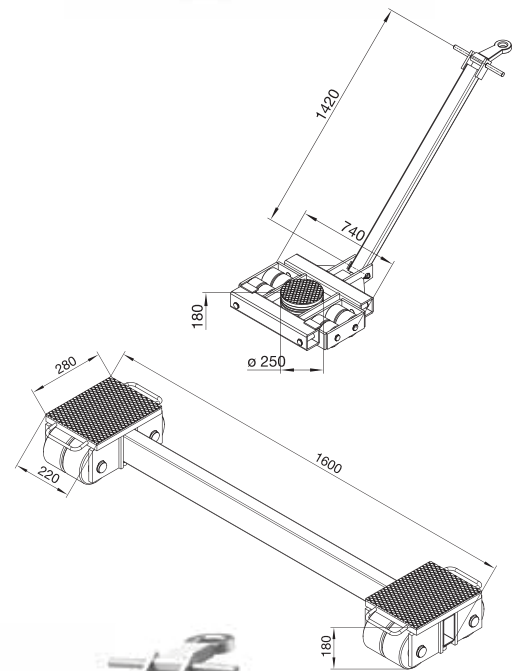

Contents
Hydraulic Toe Jacks
Pumps
Transport Dollies
Rotating Dollies
ROBOTS
Wheels
Nickel Plated Equipment



## Transport Dollies F30 / L30

### Features:

- L dolly- swivel plate to facilitate steering
- F dolly- width adjustable points of contact
- Durable, non-marking rollers
- Thick, grooved rubber pads to prevent load slippage



Technical data	F30	L30
Item number	3-11992	3-11993
Loading height / number of wheels (140 x 85mm)	7.1" / 12 180 mm / 12	7.1" / 12 180 mm / 12
Contact surface per cartridge	11.3x11.8" / 288 x 300 mm	—
Connecting bar	25.6 - 72" / 650 x 1830 mm	—
Swivel plate ø 250 mm, steering angle	—	±90°
Steering rod	—	63.8"/1620mm
Overall dimensions (L x W)	—	32.3 x 37.5" / 820 x 952 mm
Tare weight	282 lbs./ 128 kg	472 lbs./ 214 kg
Load Capacity	66,000 lbs. / 300 kN (30 t)	66,000 lbs. / 300 kN (30 t)
Total load capacity	132,000 lbs. / 600 kN (60 t)	

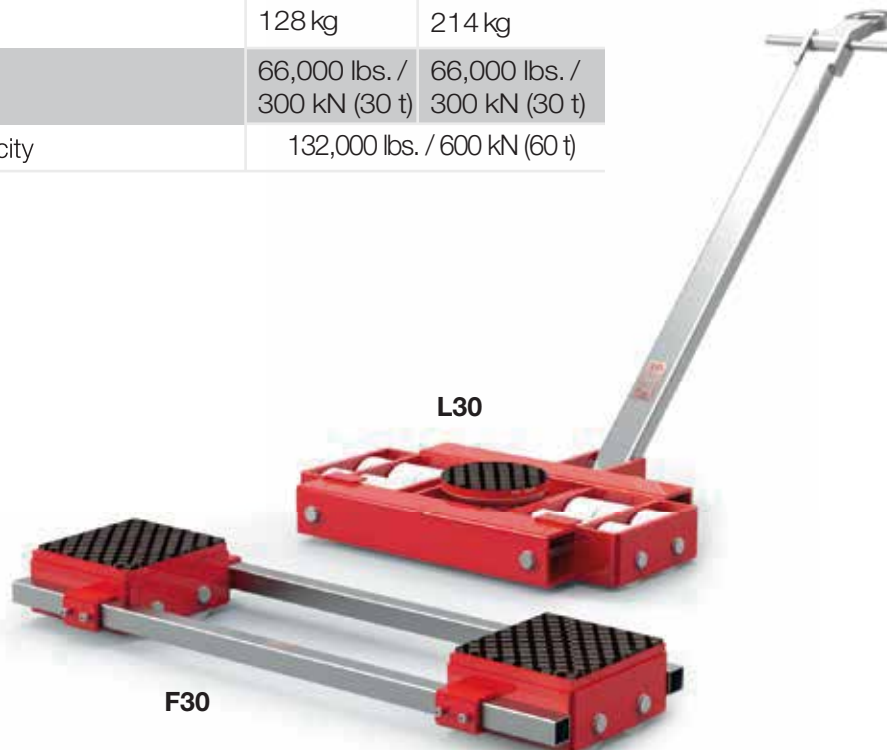
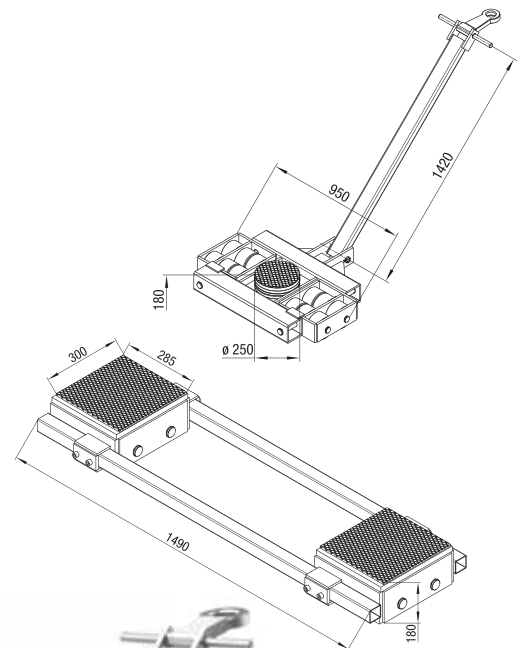



## Transport Dollies F40 / L40

- Features:**
- L dolly- includes towing eye for easy transport of the load
  - F dolly- two connecting bars for greater stability
  - High durability wheels that are non-marking
  - All wheels are boxed in for protection

Technical data	F40	L40
Item number	3-11770	3-11771
Loading height / number of wheels (140 x 85mm)	7.1" / 16 180 mm / 16	7.1" / 16 180 mm / 16
Contact surface per cartridge	14.6x14.6" / 370 x 370 mm	—
Connecting bar	29.1 - 71.1" / 740 x 1820 mm	—
Swivel plate ø 250 mm, steering angle	—	± 90°
Steering rod	—	63.8" / 1620mm
Overall dimensions (L x W)	—	47.4 x 33.7" / 1204x855mm
Tare weight	463 lbs. / 210 kg	582 lbs. / 264 kg
Load Capacity	88,000 lbs. / 400 kN (40 t)	88,000 lbs. / 400 kN (40 t)
Total load capacity	176,000 lbs. / 800 kN (80 t)	

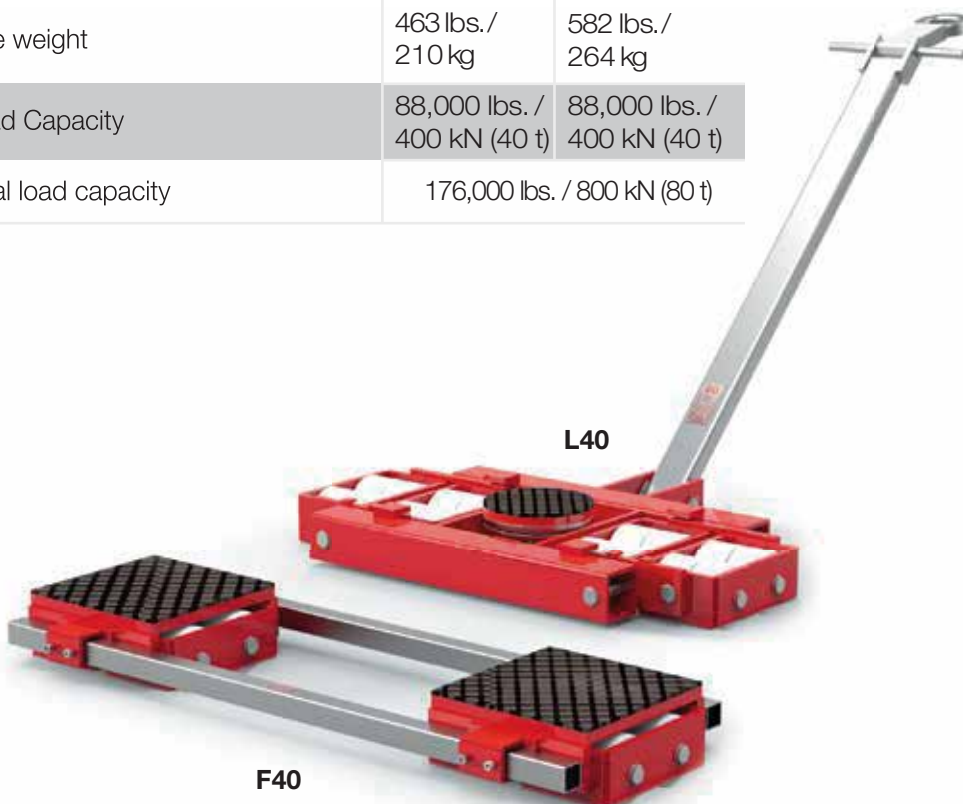
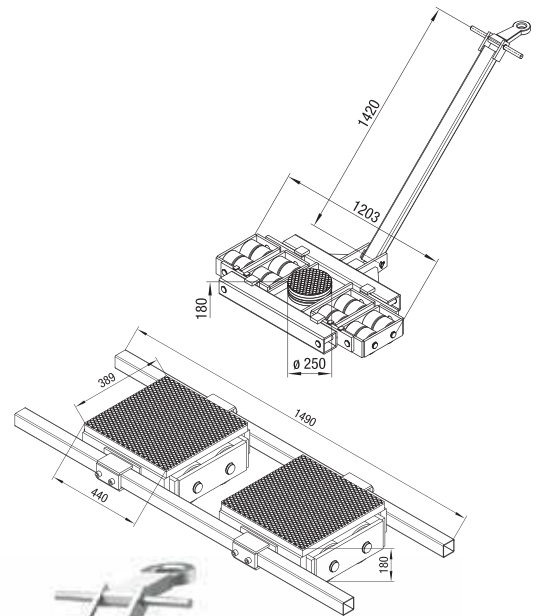
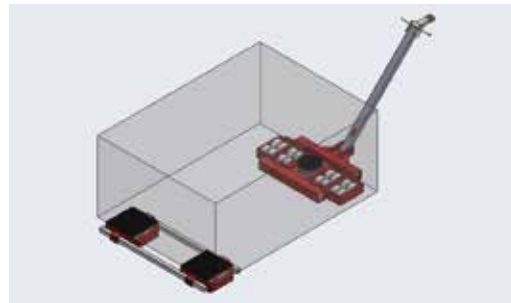

- Contents
- Hydraulic Toe Jacks
- Pumps
- Transport Dollies
- Rotating Dollies
- ROBOTS
- Wheels
- Nickel Plated Equipment





## Transport Dollies F60 / L60

### Features:

- L dolly- swivel plate to facilitate steering
- F dolly- width adjustable points of contact
- Durable, non-marking rollers
- All wheels are boxed in for protection

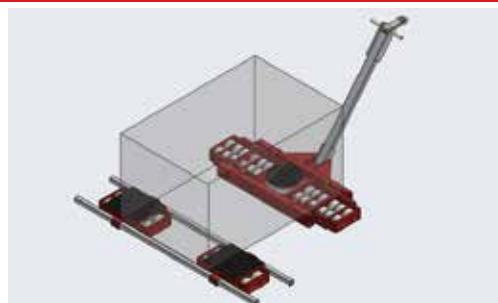

Technical data	F60	L60
Item number	3-10226	3-10227
Loading height / number of wheels (140 x 85mm)	7.1" / 24 180 mm / 24	7.1" / 24 180 mm / 24
Contact surface per cartridge	15.4 x 17.3" / 390 x 440 mm	—
Connecting bar	43.3 - 107.5" / 1100 x 2730 mm	—
Swivel plate ø 340 mm, steering angle	—	±90°
Steering rod	—	63.8"/1620 mm
Overall dimensions (L x W)	—	32.9 x 66.5"/ 835 x 1690 mm
Tare weight	639 lbs./ 290 kg	959 lbs./ 435 kg
Load Capacity	132,000 lbs./ 600 kN (60 t)	132,000 lbs./ 600 kN (60 t)
Total load capacity	264,000 lbs. / 1200 kN (120 t)	

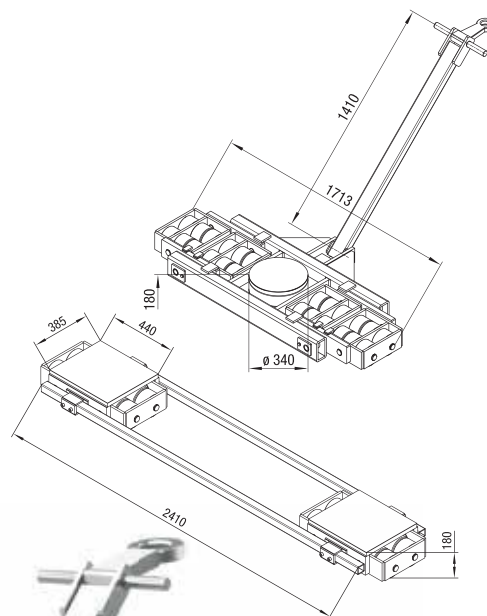

Need higher capacity?  
Call us at 937-324-8867 to see how we can help!

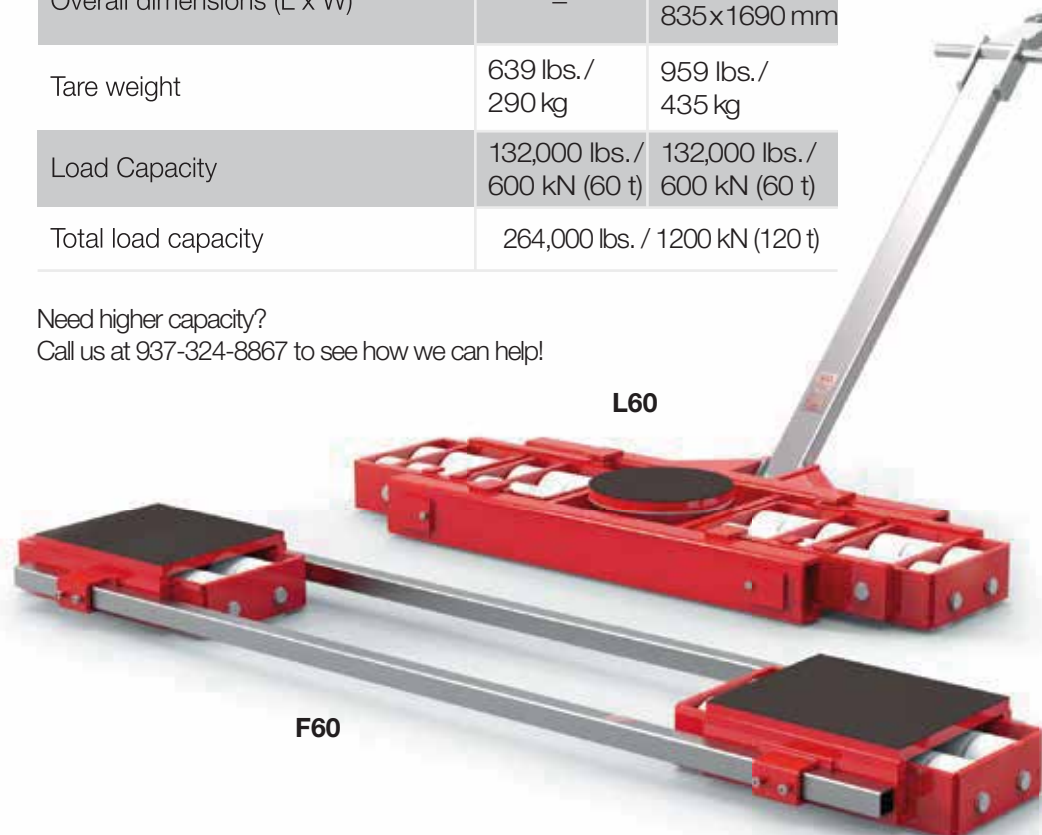

L60

F60



## Tandem Dolly TL6

- Features:**
- Designed for unbalanced loads or when 4 points of support are required
  - Swivel plates to facilitate steering
  - Can be paired with a regular F dolly, or with another TL dolly when a small turn radius is desired

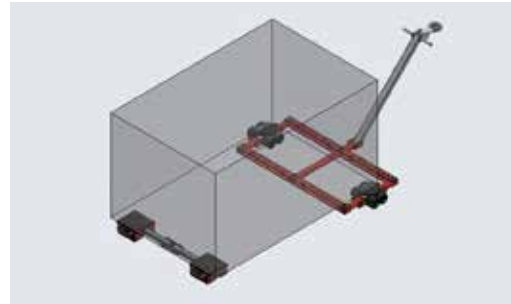

Technical data	TL6
Item number	5-10229
Loading height / number of wheels (85 x 85 mm)	4.3" / 8 110 mm / 8
2 swivel plates ø 170 mm, steering angle	±50°
Overall dimensions (L x W)	56 x 30" / 1420 x 760 mm
Adjustable width	19.7 x 45.3" / 500 x 1150 mm
Steering rod with eye for pulling	37.8" / 960 mm
Tare weight	120 lbs. / 34 kg
Load Capacity	13,200 lbs. / 60 kN (6 t)

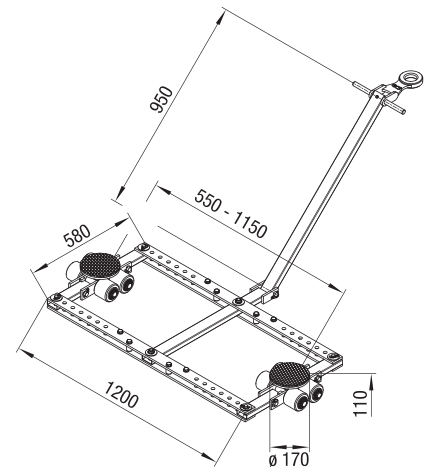

- Contents
- Hydraulic Toe Jacks
- Pumps
- Transport Dollies
- Rotating Dollies
- ROBOTS
- Wheels
- Nickel Plated Equipment



## Tandem Dolly TL12

### Features:

- Designed for unbalanced loads or when 4 points of support are required
- Swivel plates to help with maneuverability
- Can be paired with a regular F dolly, or with another TL dolly when a small turn radius is desired



### Technical data

	TL12
Item number	5-10230
Loading height / number of wheels (85 x 85 mm)	4.3" / 16 110 mm / 16
2 swivel plates $\varnothing$ 170 mm, steering angle	$\pm 40^\circ$
Overall dimensions (L x W)	63.4 x 27.8" / 1610 x 705 mm
Adjustable width	26 x 39.4" / 660 x 1000 mm
Steering rod with eye for pulling	42.5" / 1080 mm
Tare weight	232 lbs. / 105 kg
Load Capacity	26,400 lbs. / 120 kN (12 t)

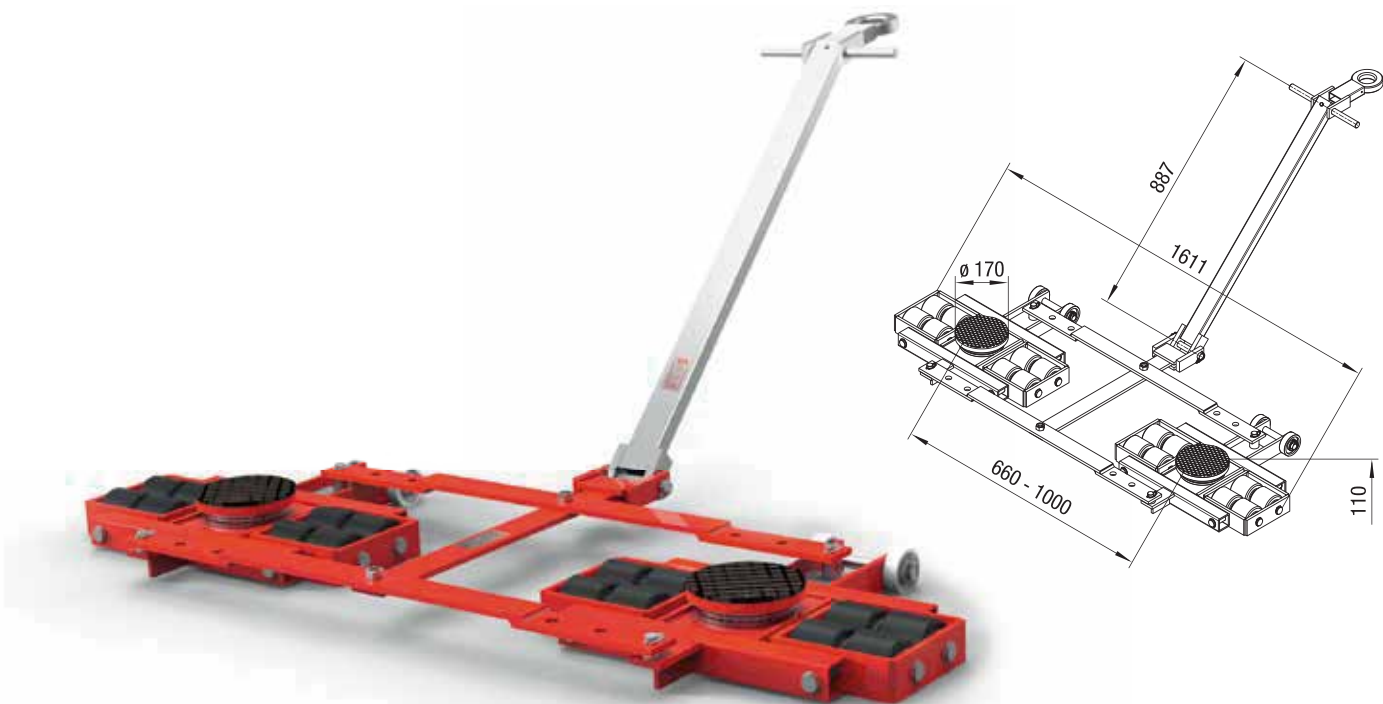



## Tandem Dolly TL20

- Features:**
- Designed for unbalanced loads or when 4 points of support are required
  - Swivel plates to help with steering
  - Can be paired with a regular F dolly, or with another TL dolly when a small turn radius is desired



Technical data	TL20
Item number	5-11803
Loading height / number of wheels (140x85 mm)	7.1" / 8 180 mm / 8
2 swivel plates ø 170 mm, steering angle	±45°
Overall dimensions (L x W)	84 x 46.5" / 2135 x 1180 mm
Adjustable width	50 x 63" / 1260 x 1600 mm
Steering rod with eye for pulling	64" / 1620 mm
Tare weight	493 lbs. / 222 kg
Load Capacity	44,000 lbs. / 200 kN (20 t)

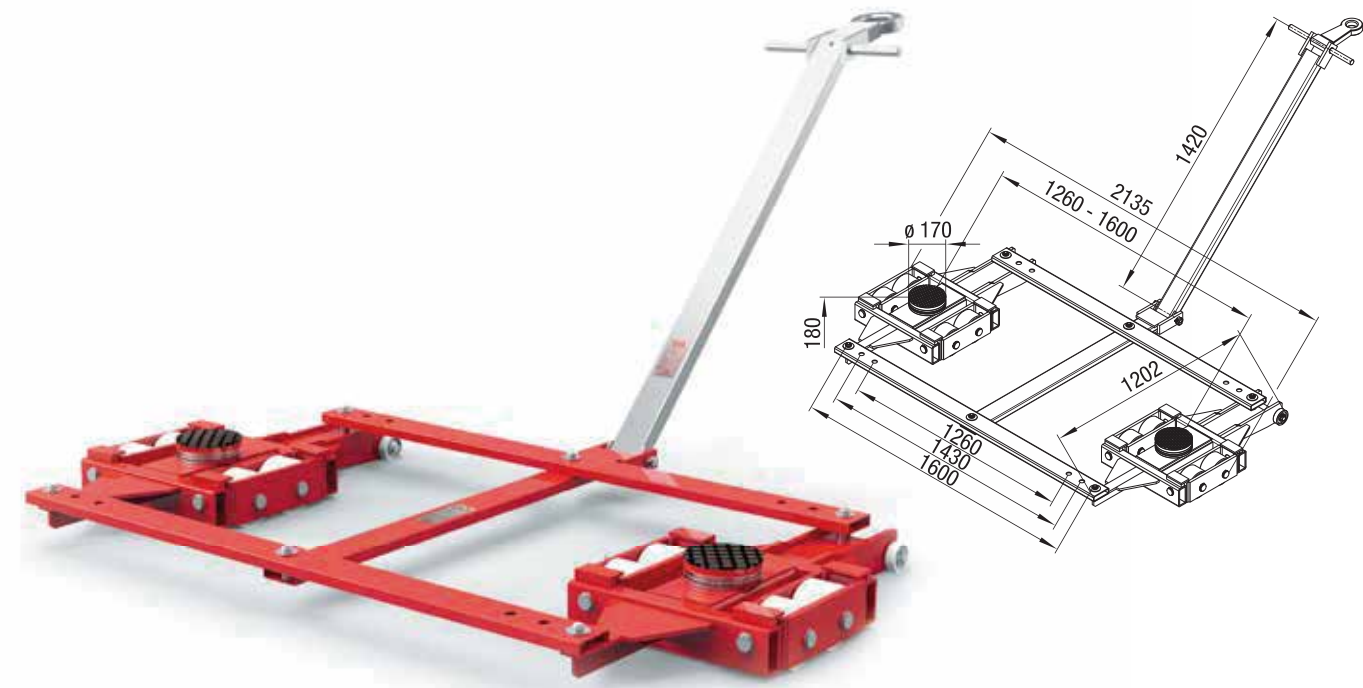

- Contents
- Hydraulic  
Toe Jacks
- Pumps
- Transport Dollies
- Rotating Dollies
- ROBOTS
- Wheels
- Nickel  
Plated Equipment



## Tandem Dolly TL40

### Features:

- Designed for unbalanced loads or when 4 points of support are required
- Swivel plates to help maneuver the load
- Can be paired with a regular F dolly, or with another TL dolly when a small turn radius is desired

### Technical data

	TL40
Item number	5-11148
Loading height / number of wheels (140x85 mm)	7.1" / 8 180 mm / 8
2 swivel plates $\varnothing$ 170 mm, steering angle	$\pm 45^\circ$
Overall dimensions (L x W)	87.4 x 46.5" / 2220 x 1180 mm
Adjustable width	50 x 63" / 1260 x 1600 mm
Steering rod with eye for pulling	64" / 1620 mm
Tare weight	578 lbs. / 260 kg
Load Capacity	88,000 lbs. / 400 kN (40 t)

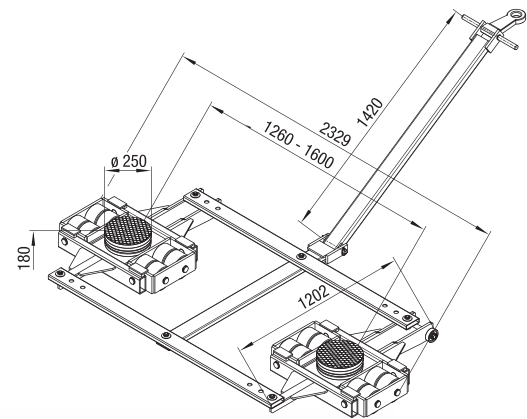

Need higher capacity?

Call us at 937-324-8867 to see how we can help!







## Container Dollies F6-c / TL6-c

- Features:**
- Features special twist locks to secure ISO containers to the dolly
  - Able to accommodate uneven loads due to 4 points of support
  - Connecting bars to increase load stability
  - Durable, non-marking rollers



Technical data	F6-c	TL6-c
Item number	5-13642	5-13643
Loading height / number of wheels (85 x 85 mm)	7" / 8 176 mm / 8	7" / 8 176 mm / 8
Overall dimensions (L x W)	—	*x 89" / 2259 mm
Tare weight	111 lbs. / 50 kg	167 lbs. / 75 kg
Load Capacity	26,400 lbs. / 120 kN (12 t)	

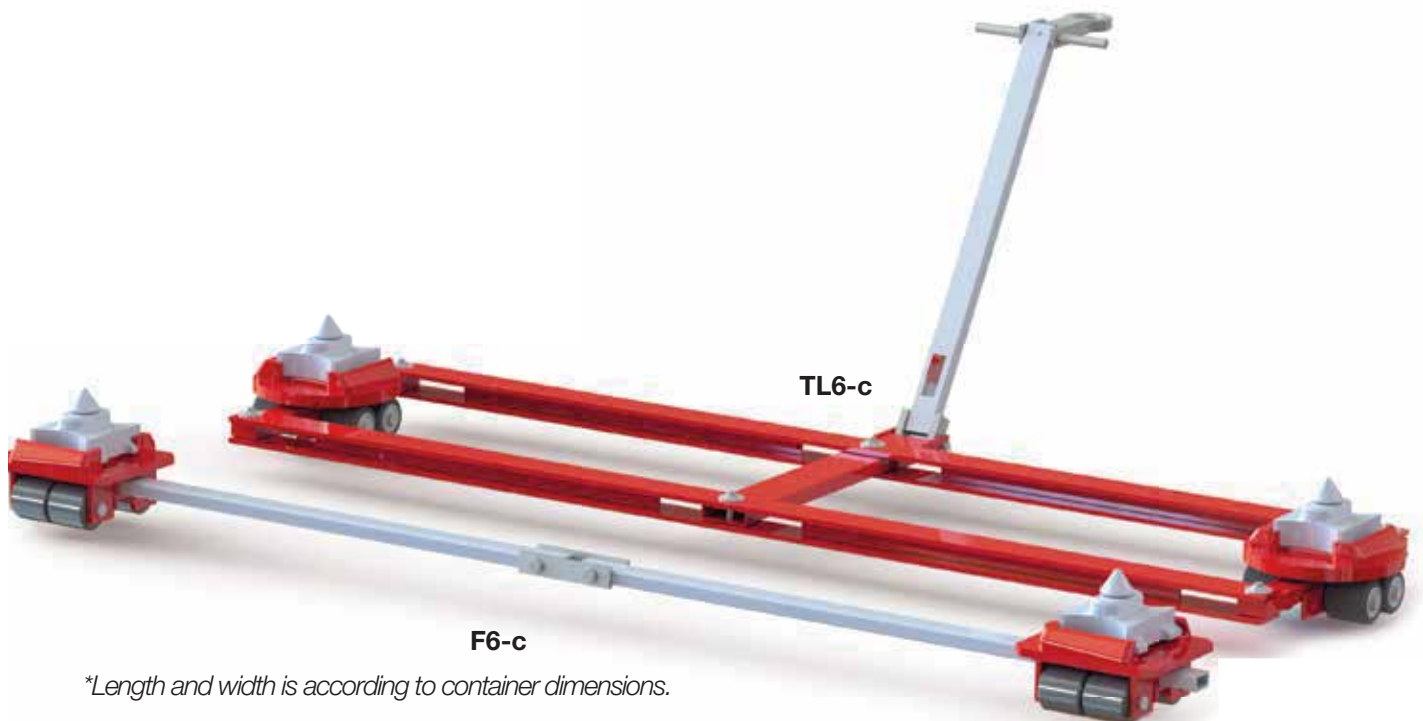
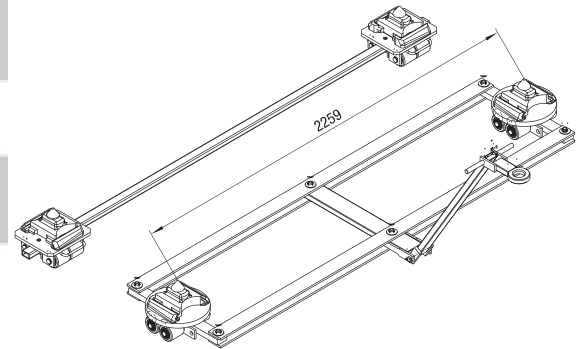

*\*Length and width is according to container dimensions.*

- Contents
- Hydraulic  
Toe Jacks
- Pumps
- Transport Dollies
- Rotating Dollies
- ROBOTS
- Wheels
- Nickel  
Plated Equipment



## Container Dollies F12-c / TL12-c

### Features:

- Specially designed twist locks to secure ISO containers to the dolly
- Accommodates uneven loads due to 4 points of support
- Connecting bars to increase load stability
- Durable, non-marking rollers



Technical data	F12-c	TL12-c
Item number	5-14130	5-14129
Loading height / number of wheels (85 x 85 mm)	7" / 16 176 mm / 16	7" / 16 176 mm / 16
Overall dimensions (L x W)	—	*x 89" / 2259 mm
Tare weight	136 lbs. / 61 kg	344 lbs. / 155 kg
Load Capacity	52,800 lbs. / 240 kN (24 t)	

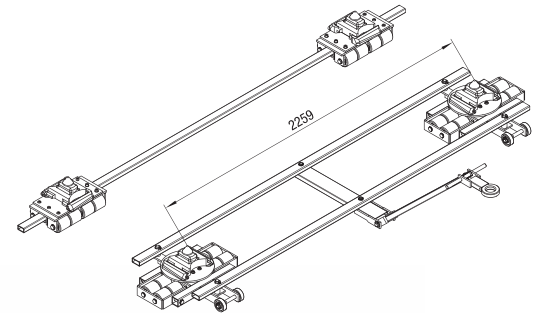

Need higher capacity?  
Call us at 937-324-8867 to see how we can help!

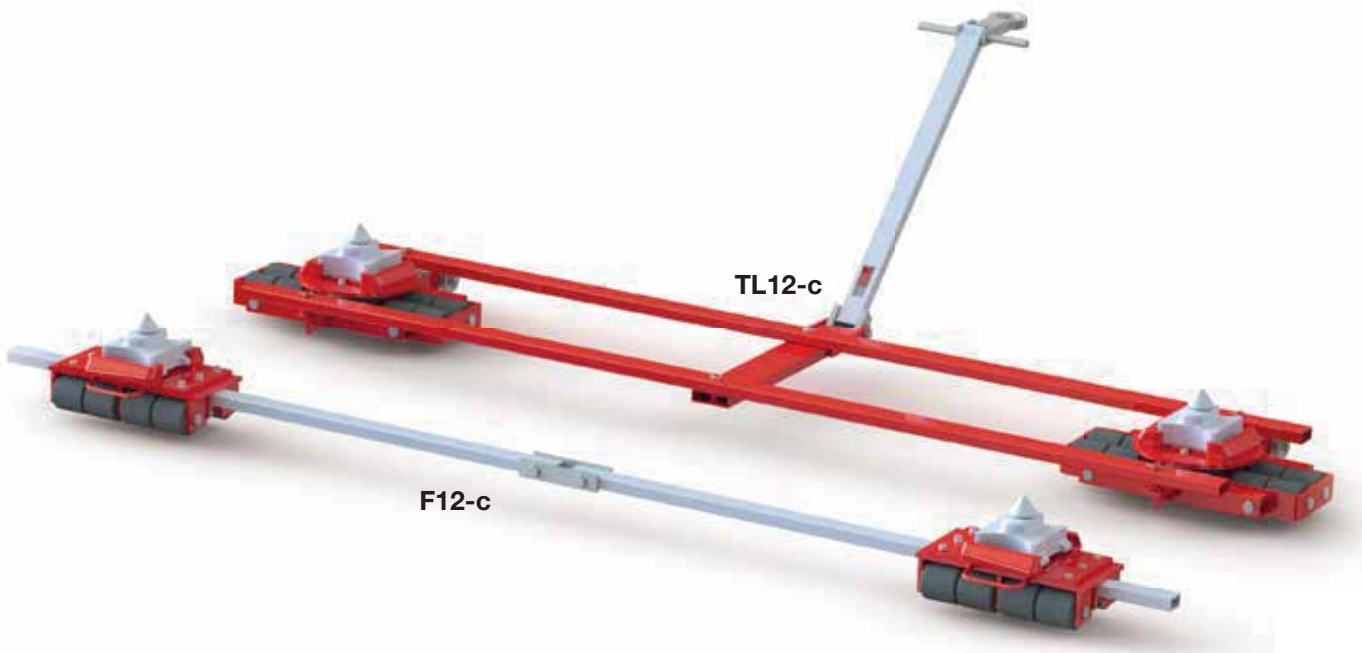

*\*Length and width is according to container dimensions.*



## Twinlifter TW2800

**Twinlifter TW2800**

- Ideal for transporting bulky heavy loads, such as safes
- 2 hydraulic units for lifting
- Tandem steering
- One of the highest capacity lifting dollies on the market



Twinlifter	TW2800	
Item number	1-14169 (PA wheels)	1-13687 (PUR wheels)
Load capacity per pair	6,294 lbs. / 28 kN (2,8 t)	
Weight	130 lbs. / 60 kg	
Lifting height max.	7" / 177 mm	
Overall height	39.3" / 1000 mm	
Width	25.6" / 650 mm	
Loading height	0.2" / 5mm	
Min. wheel diameter of the PA wheels	7.9" / 200 mm	
Length of lashing strap with tension ratchet	315" / 8000 mm	

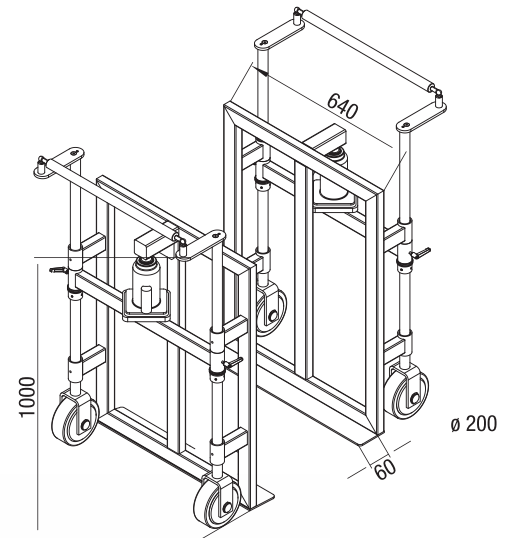

- Contents
- Hydraulic Toe Jacks
- Pumps
- Transport Dollies
- Rotating Dollies
- ROBOTS
- Wheels
- Nickel Plated Equipment

# Rotating Dollies

RL





# Rotating Dollies RL



Sick of using straight line rollers? It'd be great if loads only needed to be moved in straight lines, but GKS-PERFEKT knows that isn't how life works. Our rotating dollies have special bearings that allow for 360-degree movement on its own axis, giving you the most maneuverability possible. Optional accessories include connecting bars and a steering rod.

## Rotating Dolly RL 4

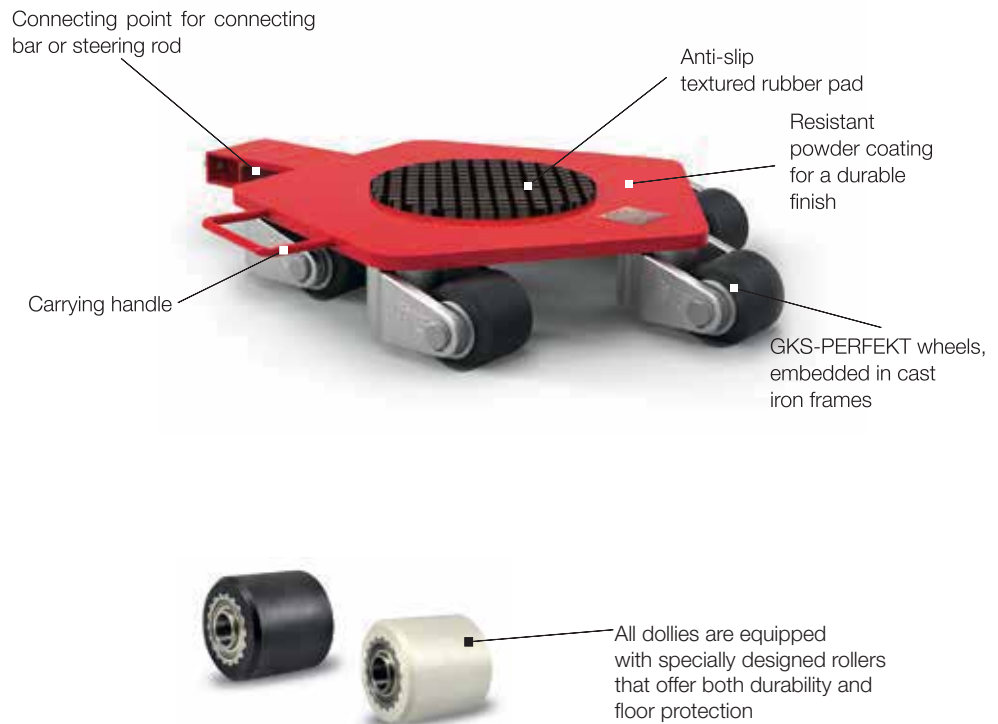

**To connect several rotating dollies, connecting bars of various lengths and steering rods are available.**

Contents

Hydraulic  
Toe Jacks

Pumps

Transport Dollies

Rotating Dollies

ROBOTS

Wheels

Nickel  
Plated Equipment





## Rotating Dolly RL1

### Features:

- 360-degree movement due to special bearings
- Low loading height
- Durable, non-marking rollers

### Technical data

	RL1
Item number	6-11456
Loading height / number of wheels (85 mm x 85 mm)	3.9" / 3 100 mm / 3
Overall dimensions (L X W X H)	14.8 x 15 x 3.9" 376 x 379 x 100 mm
Tare weight	33 lbs. / 15 kg
Load Capacity	2,200 lbs. / 10 kN (1 t)

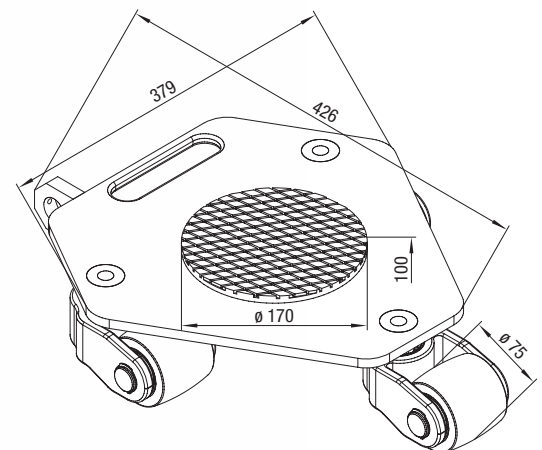



## Rotating Dolly RL2

- Features:**
- Ideal for tight turns due to 360-degree capabilities
  - Minimal loading height
  - Thick, grooved rubber pad to prevent load slippage



Technical data	RL2
Item number	6-10238
Loading height / number of wheels (85 mm x 85 mm)	4.3"/3 110 mm / 3
Overall dimensions (L X W X H)	27 x 20.2 x 4.3"/ 685 x 515 x 110mm
Tare weight	66 lbs. / 30 kg
Load Capacity	4,400 lbs. / 20 kN (2 t)

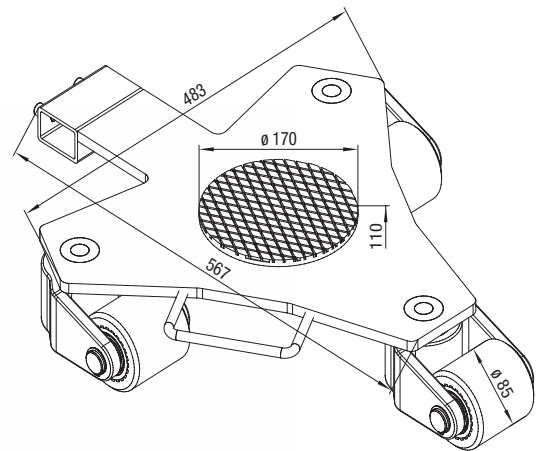

- Contents
- Hydraulic Toe Jacks
- Pumps
- Transport Dollies
- Rotating Dollies
- ROBOTS
- Wheels
- Nickel Plated Equipment



## Rotating Dolly RL4

- Features:**
- 360-degree movement due to special bearings
  - Low loading height
  - Durable, non-marking rollers



Technical data	RL4
Item number	6-10240
Loading height / number of wheels (85 mm x 85 mm)	4.3" / 5 110 mm / 5
Overall dimensions (L X W X H)	29.9 x 22.1 x 4.3" / 760 x 560 x 110 mm
Tare weight	111 lbs. / 50 kg
Load Capacity	8,800 lbs. / 40 kN (4 t)

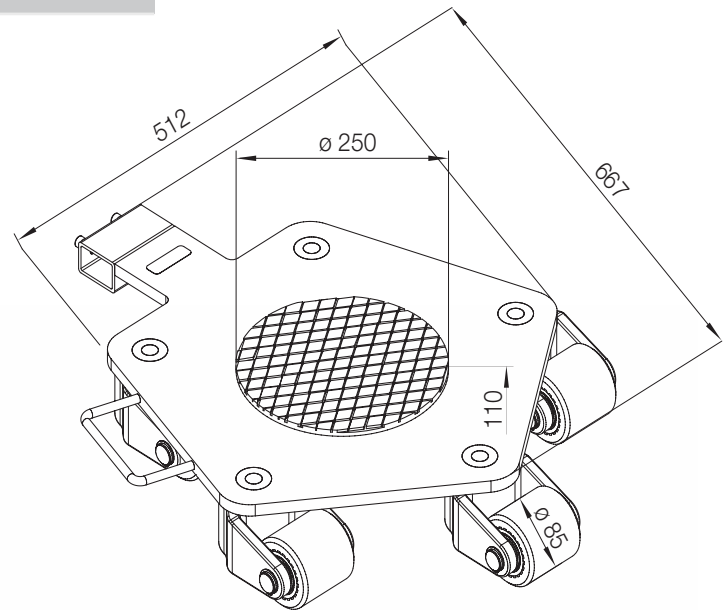



## Rotating Dolly RL6

**Features:**  
 360-degree movement due to special bearings  
 Low loading height  
 Durable, non-marking rollers

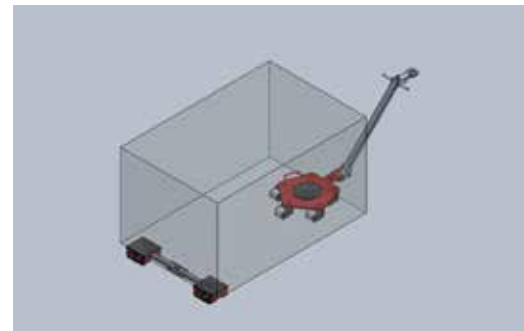

Technical data	RL6
Item number	6-13439
Loading height / number of wheels (85 mm x 85 mm)	4.6" / 5 118 mm / 5
Overall dimensions (L X W X H)	29.9 x 22.1 x 4.6" / 760 x 560 x 118 mm
Tare weight	133 lbs. / 60 kg
Load Capacity	13,200 lbs. / 60 kN (6 t)

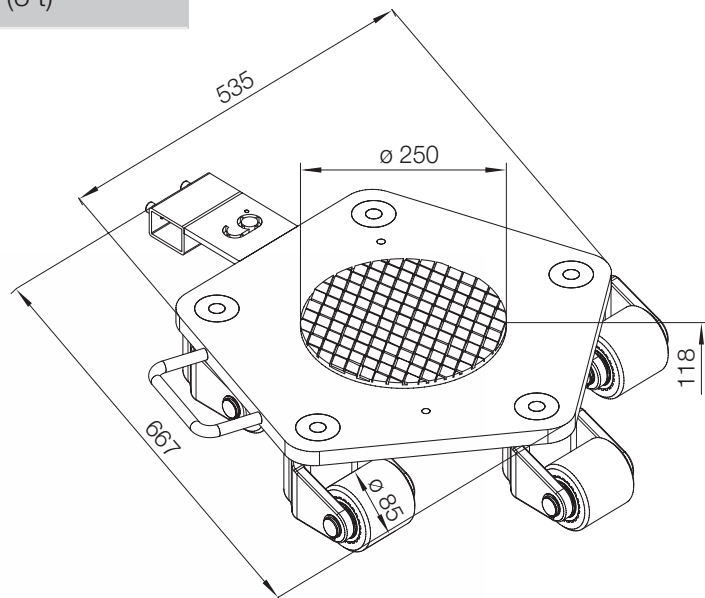

- Contents
- Hydraulic  
Toe Jacks
- Pumps
- Transport Dollies
- Rotating Dollies
- ROBOTS
- Wheels
- Nickel  
Plated Equipment



## Rotating Dolly RL6-D

### Features:

- Front wheels remain straight, while back wheels turn freely
- Swivel plate is adjustable and facilitates steering
- Combines maneuverability of regular rotating dollies while making straight line movement easier
- Handlebar is included



Technical data	RL6-D
Item number	6-15584
Loading height/number of wheels:	6.3" / 4 158 mm / 4
Overall dimensions (L X W X H)	21.1 x 20.5 x 6.3" / 535 x 520 x 158 mm
Tare weight	104 lbs. / 47 kg
Load Capacity	13,200 lbs. / 60 kN (6 t)

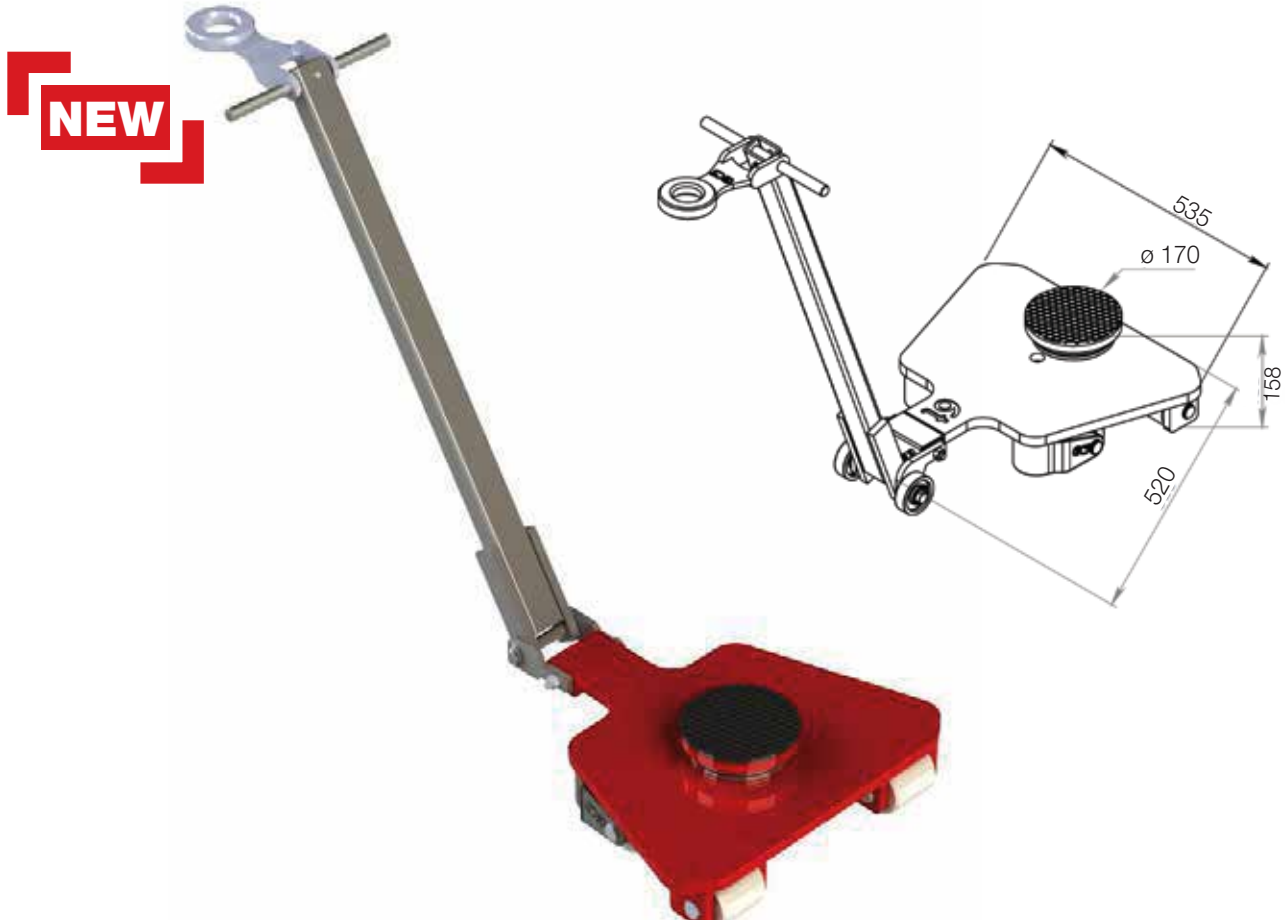





## Rotating Dolly RL8

- Features:**
- Ideal for tight turns due to 360-degree capabilities
  - Minimal loading height
  - Long lasting rollers that don't mark floors

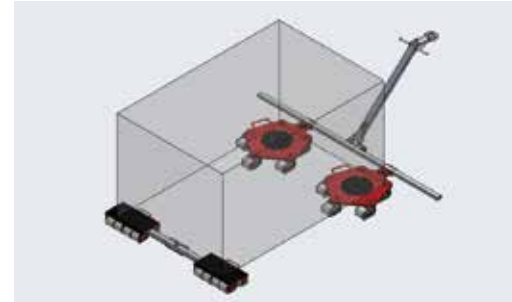

Technical data	RL8
Item number	6-13817
Loading height / number of wheels (85 mm x 85 mm)	4.6" / 5 118 mm / 5
Overall dimensions (L X W X H)	29.9 x 22.1 x 4.6" / 760 x 560 x 118mm
Tare weight	133 lbs. / 60 kg
Load Capacity	17,600 lbs. / 80 kN (8 t)

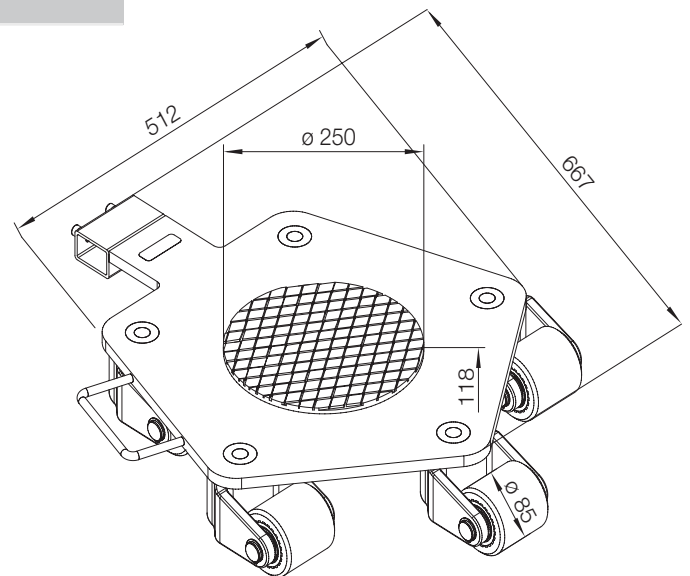

- Contents
- Hydraulic Toe Jacks
- Pumps
- Transport Dollies
- Rotating Dollies**
- ROBOTS
- Wheels
- Nickel Plated Equipment



## Rotating Dolly RL12

- Features:**
- 360 degree movement due to special bearings
  - Long lasting rollers that don't mark floors
  - Thick, grooved rubber pad to prevent load slippage



Technical data	RL12
Item number	6-13818
Loading height / number of wheels (140 mm x 85 mm)	7.1" / 5 180 mm / 5
Overall dimensions (L X W X H)	38.6 x 32.1 x 7.2" / 981 x 815 x 183 mm
Tare weight	408 lbs. / 185 kg
Load Capacity	26,400 lbs. / 120 kN (12 t)

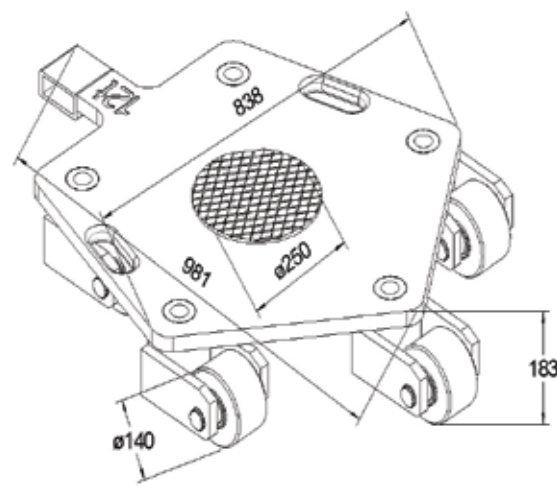



Rotating Dolly Accessories

**HANDLEBAR:** **CONNECTING BAR:**



**Get a handlebar for your rotating dollies.**  
 Make maneuverability and towing of the load easier!  
 Towing eye is included.



**Moving on an uneven floor?**  
 Increase load stability by acquiring a connecting bar to prevent slip outs from the load.  
 Available in lengths of 1.5 and 2 meters.

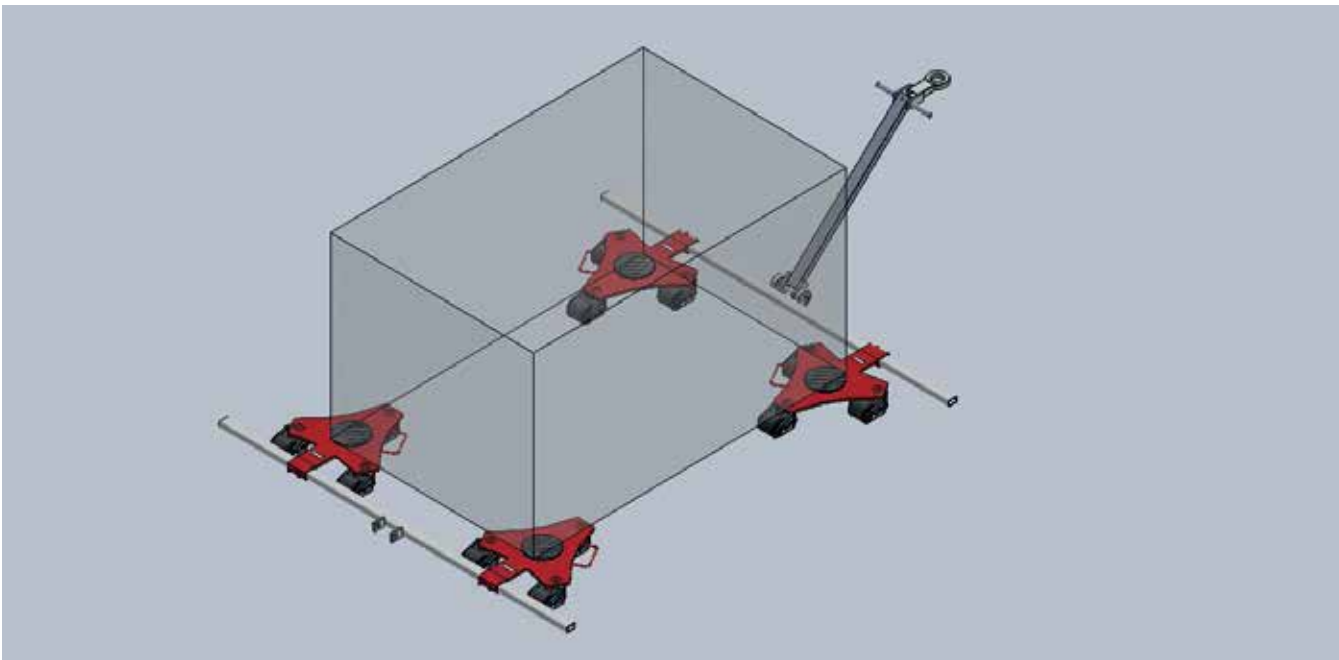

- Contents
- Hydraulic Toe Jacks
- Pumps
- Transport Dollies
- Rotating Dollies**
- ROBOTS
- Wheels
- Nickel Plated Equipment

# Wheels



# GKS Wheels Selection

Our high quality GKS-PERFEKT wheels are the result of our own development, innovation, and endurance tests. Not only are our wheels designed to withstand large capacities and roll smoothly, they also do not damage floors. In addition to our standard wheels, we also offer wheels for sensitive flooring and high temperature applications upon request.



## GKS ROBOT Wheels

Our ROBOT wheels were specifically designed for our unit, and are made with an engineered material called Naphthylendiisocyanat, which gives our ROBOT wheels 2.5 times the strength of a solid roller.

Contents

Hydraulic  
Toe Jacks

Pumps

Transport Dollies

Rotating Dollies

ROBOTS

Wheels

Nickel  
Plated Equipment





## GKS Wheels Selection

### GKS-ALPERFEKT® PREMIUM

Our standard wheels for dollies with 4.3" loading height. Made of a high-grade polyamide which allows for high capacity while rolling effortlessly. Contains an aluminum core with gripping teeth to ensure long life. Non-marking on standard floors.

### GKS-ALPERFEKT® PREMIUM G

Our standard wheel for dollies with a 7.1" loading height. A specially designed aluminum alloy ball-bearing, along with a bigger diameter, gives this roller a higher capacity.

#### Technical Data

#### GKS-ALPERFEKT® PREMIUM

	Black	White
Item number	4-10015	4-10018
Size in inches/mm	3.3x3.3"/ 85x85 mm	
Clean, even flooring	•	
Impure flooring	•	
Flooring with slight ridges	•	
Heavily contaminated floors		
Sensitive floors		

#### Technical Data

#### GKS-ALPERFEKT® PREMIUM G

	White
Item number	4-10022
Size in inches/mm	5.3x3.3"/ 140x85 mm
Clean, even flooring	•
Impure flooring	•
Flooring with ridges	•
Heavily contaminated floors	
Sensitive floors	





## GKS Wheels Selection

### GKS-ALPERFEKT® PUR

A specialty wheel meant for applications with sensitive flooring—the polyurethane coating helps protect the floor while maintaining high capacities.

### GKS-ALPERFEKT® STEEL

Steel wheels are recommended for high temperature applications where normal wheels would melt, heavily contaminated floors, or outdoor conditions. If protecting the floor is not a priority and the durability of the roller is more important, then steel wheels are the right choice.

#### Technical Data

#### GKS-ALPERFEKT® PUR

#### Grey

	4-11769	4-12007
Item number	4-11769	4-12007
Size in inches/mm	3.3 x 3.3"/ 85 x 85 mm	5.3 x 3.3"/ 140 x 85 mm
Clean, even flooring		
Impure flooring		
Flooring with slight ridges		
Heavily contaminated floors		
Sensitive floors		•

#### Technical Data GKS-ALPERFEKT® STEEL

#### Silver

	4-10016	4-10258
Item number	4-10016	4-10258
Size in inches/mm	3.3 x 3.3"/ 85 x 85 mm	5.3 x 3.3"/ 140 x 85 mm
Clean, even flooring		
Impure flooring		•
Flooring with ridges		•
Heavily contaminated floors		•
Sensitive floors		





Dirección: Batalla de Trinidad No. 3109  
Residencial Revolución, Tlaquepaque,  
Jalisco, México C.P. 45580  
gdl@heavycargo.net  
www.heavycargo.net

 heavycargo



3331217237



3312206656